

Proposal to Establish a New Non-Denominational Secondary School in Kirkliston and implement Catchment Changes

Tuesday 10 October 2023,
Kirkliston Primary School



www.edinburgh.gov.uk/kirklistonhs



Introductions

- **Tom Wood** – Chair
- **Cllr Joan Griffiths** – Convenor of Education, Children and Families Committee
- **Lorna French** – Service Director Education and Chief Education Officer
- **David Givan** – Chief Planning Officer and Head of Building Standards
- **Robbie Crockatt** – Strategic Asset Planning Manager
- **Vincent Spicer** – Quality Improvement Officer, Learning Estate
- **Julie Duncan** – Portfolio Planner



Background & Context

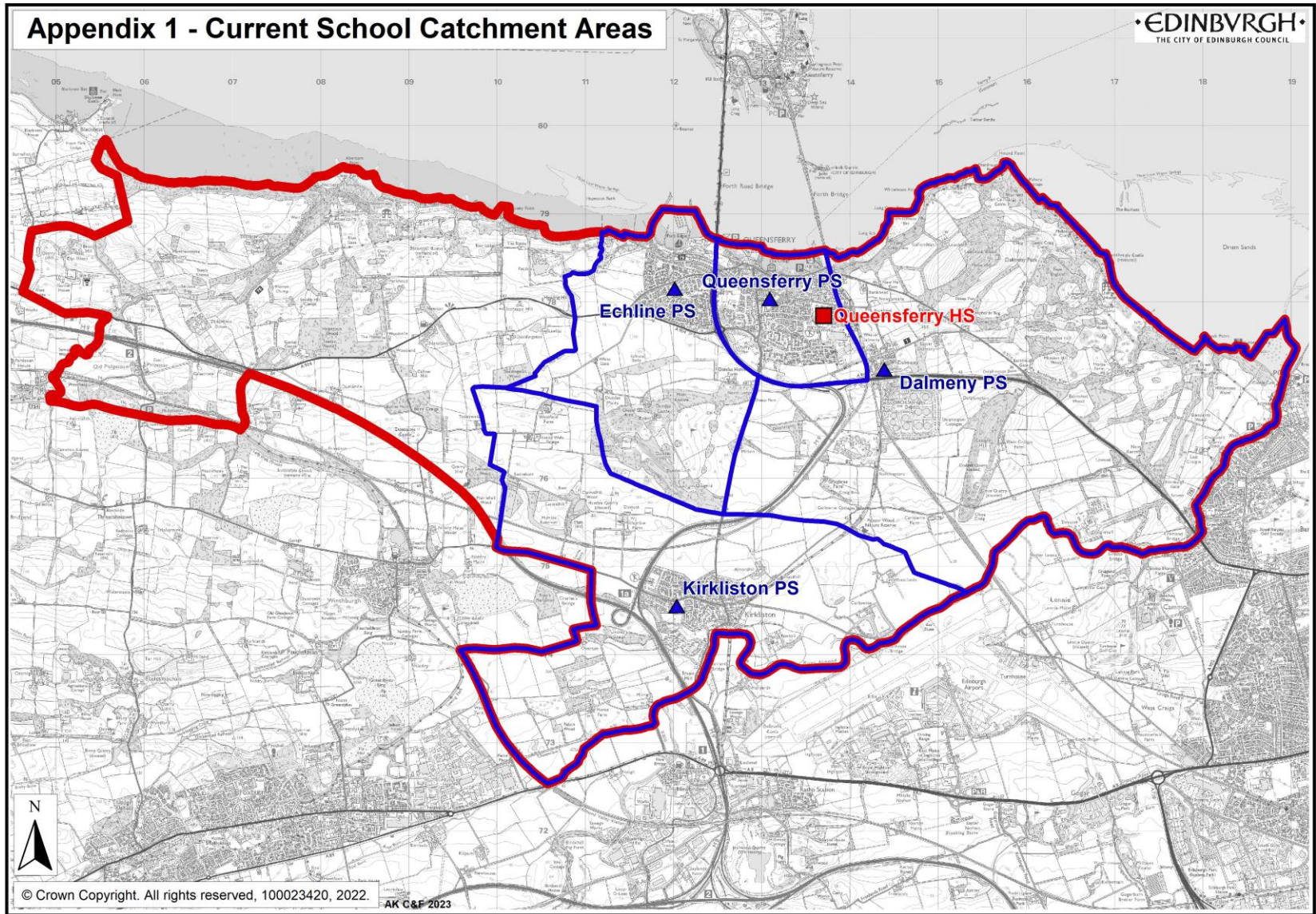

Background & Context

- Queensferry High School capacity is 1,200 pupils.
- Current projections suggest roll of 1,654 by 2031.
- Designed and funded in 2016 on basis of Kirkliston being realigned with another school.

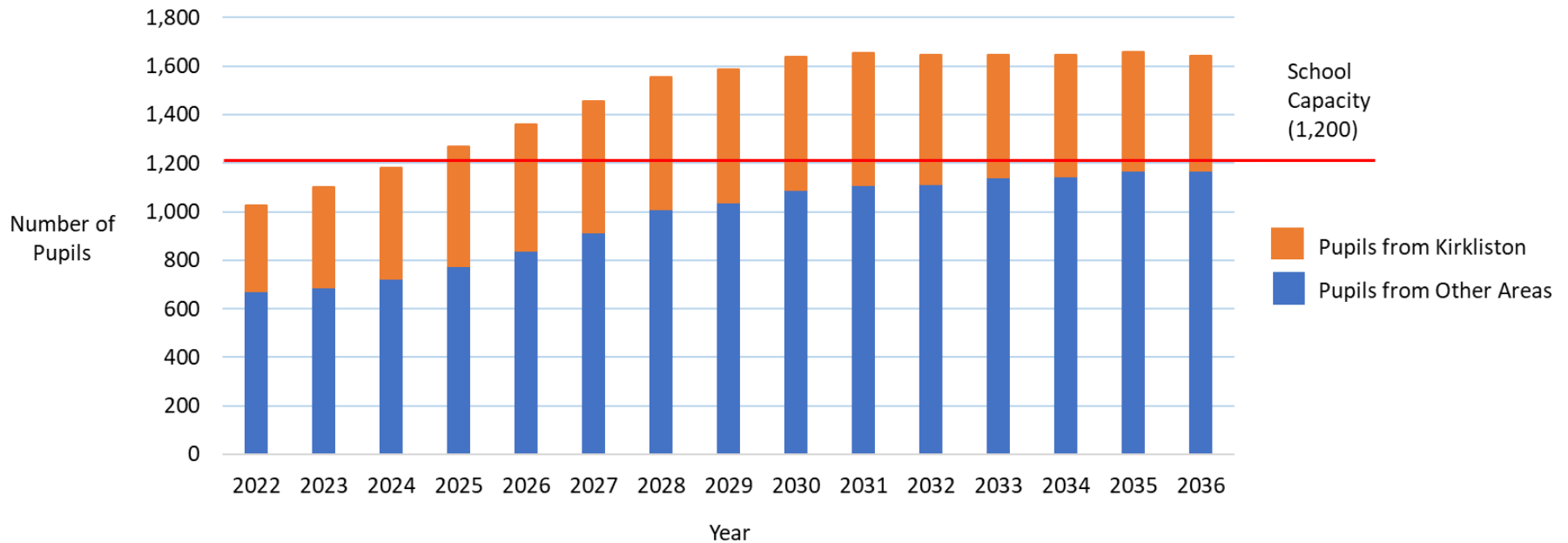

Background & Context

Previous Options

1. New secondary school in West Edinburgh at the International Business Gateway (IBG) site.
2. Winchburgh Academy.
3. A new secondary school at Ratho Station.
4. Burnshot Road site.
5. New secondary school in West Edinburgh at the West Town site.
6. Extend Queensferry High School

Rejected because...

- Travel and Transport
- West Lothian: term dates, education approach
- Travel and Transport
- Greenbelt
- Travel and community links
- School too big

Background & Context

A Secondary School in Kirkliston

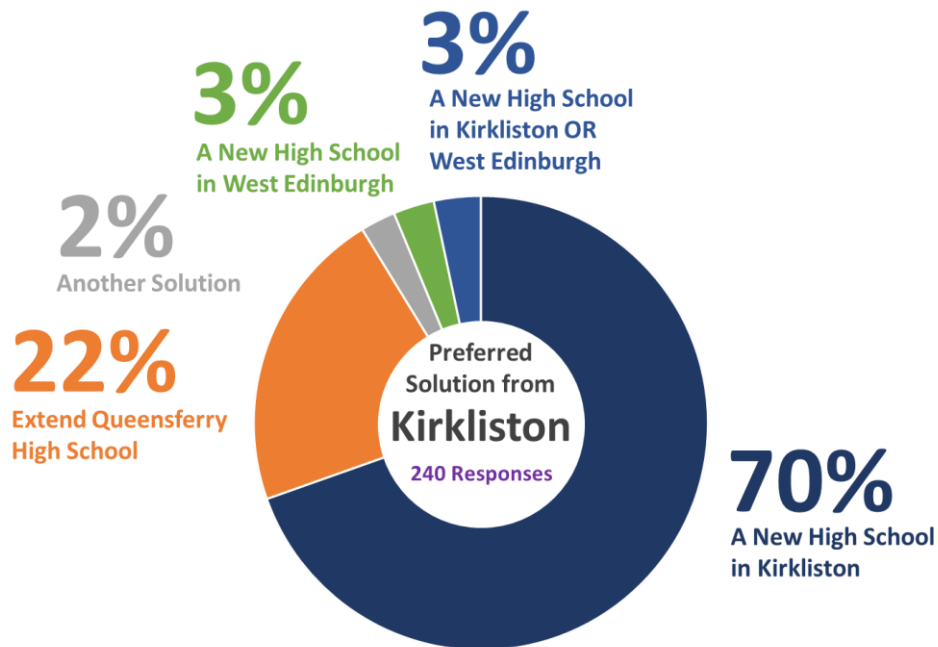

Why?

- Reducing travel time and increasing active travel.
- Improving facilities in Kirkliston.
- Long-term strategic planning.

Informal engagement, January 2023

Background & Context

Where to Build a Secondary School in Kirkliston?

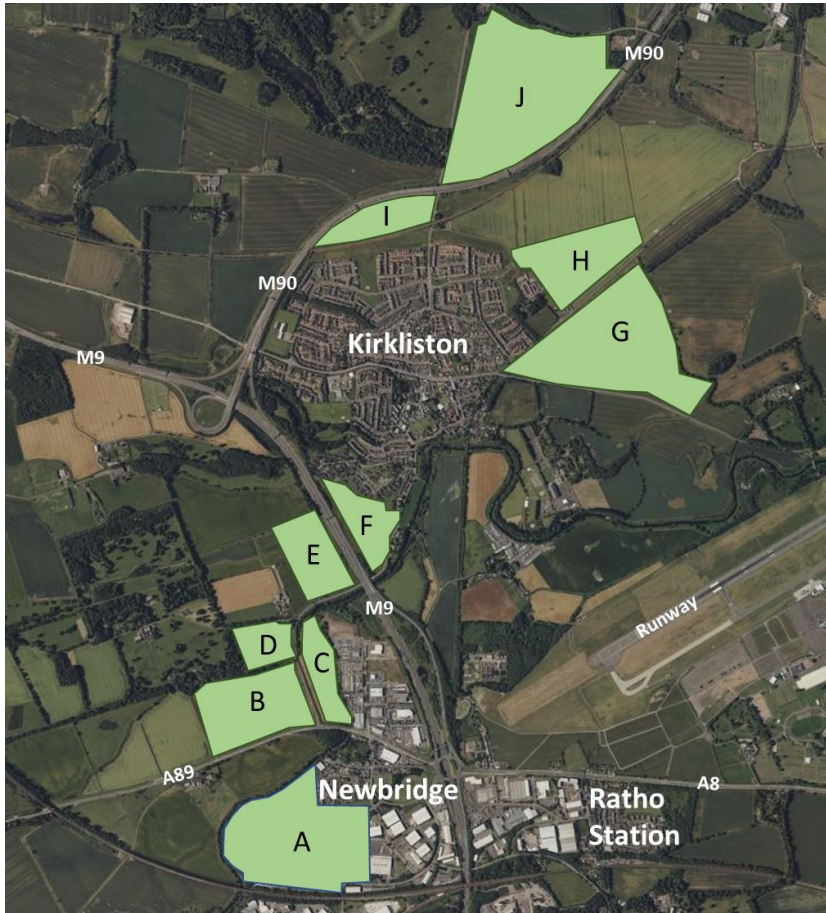

- Very few (<20) responses commenting on a site.
- Preferences and Suggestions:
 - Sites in the north-east of the village around Burnshot Road;
 - Redevelopment of the Leisure Centre site on the west of the village.

Informal engagement, January 2023

Background & Context

Kirkliston Leisure Centre Site

- Previously excluded because its small size, its proximity to the motorway and existing residential properties;
- However;
 - Advice from Planning made it clear that other sites likely to be undeliverable;
 - The Leisure Centre site is the only site in Council ownership (potentially reducing costs and timescales).
- Commissioned architects (ADP) to look at site in detail to establish whether school could be accommodated on the site.

Background & Context

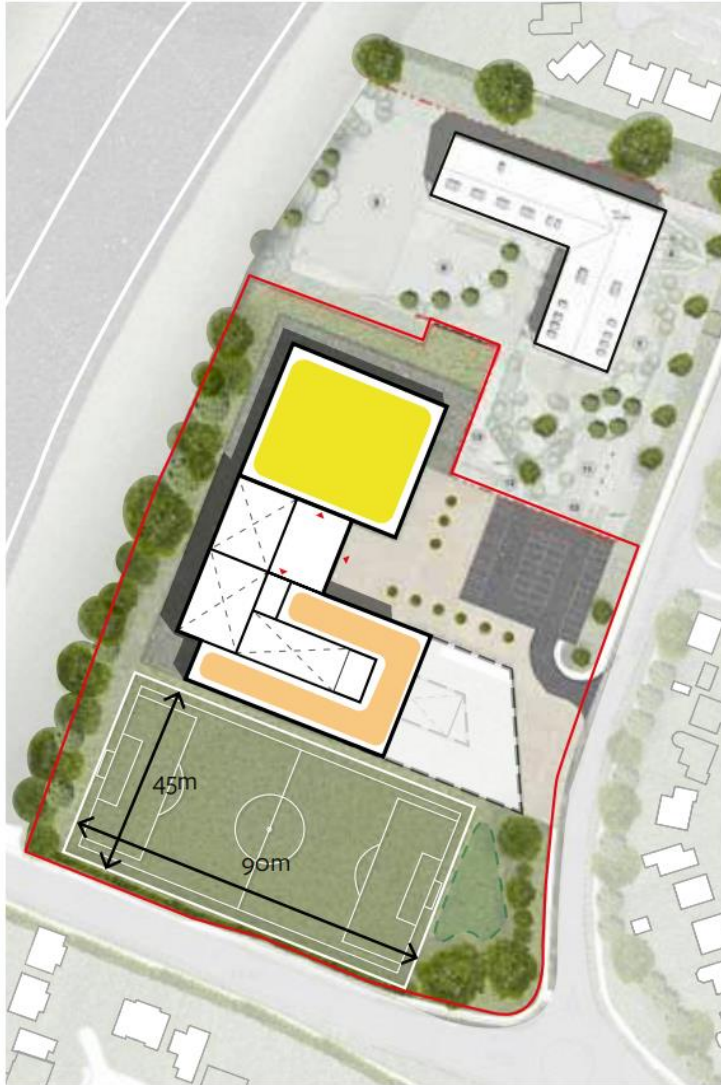

Background & Context

Informal Engagement on Kirkliston Leisure Centre Site

2%

EXPRESSED NO PREFERENCE

62%

NOT SUITABLE FOR A NEW HIGH SCHOOL

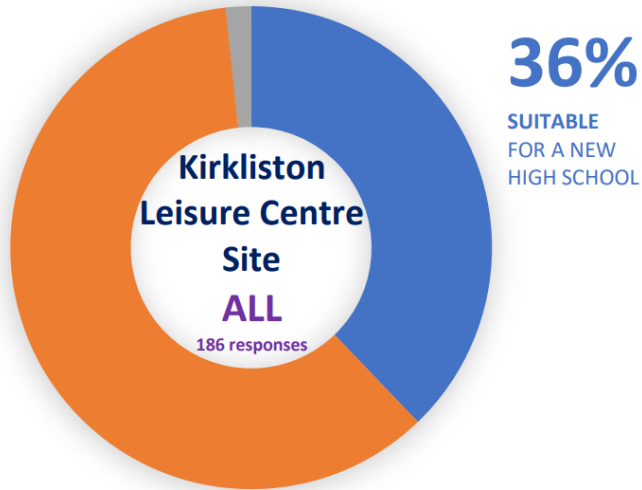

Reasons for rejecting the Leisure Centre site

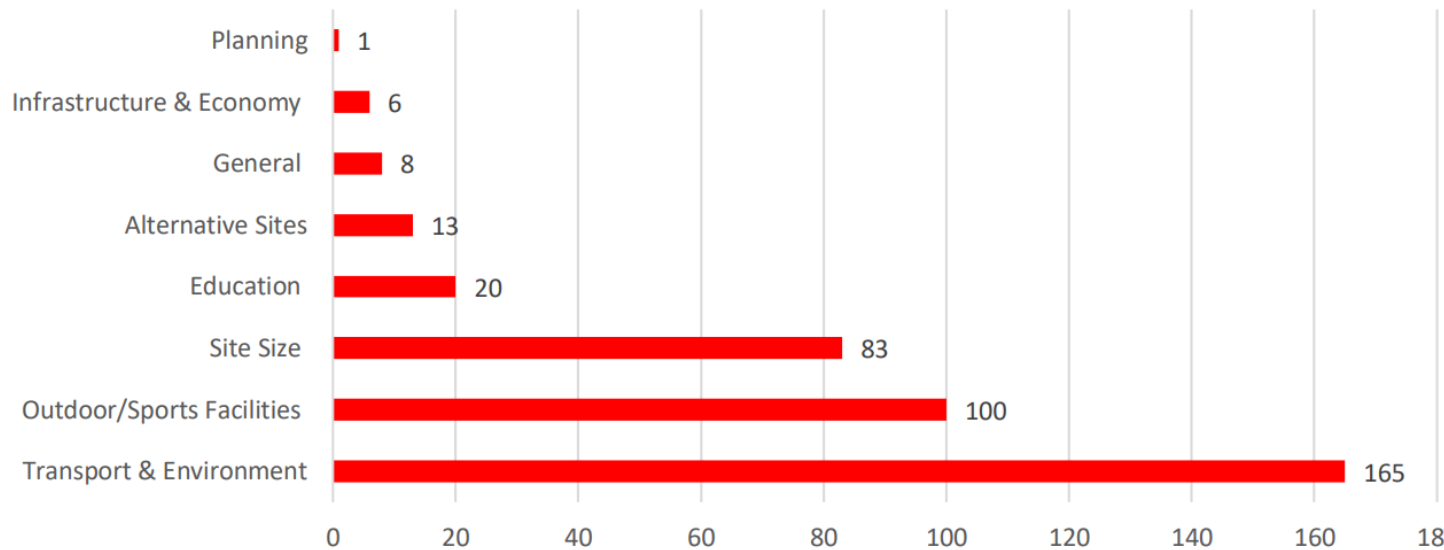

Background & Context

Why progress Statutory Consultation on Kirkliston Leisure Centre Site?

1. There is clear support for a new secondary school in Kirkliston.
2. The Leisure Centre site is currently the only site that we can build a school on due to restrictions on all other potential sites.
3. The timescales for delivery of a school on the Leisure Centre site are within our control.
4. We believe that the major concerns previously expressed – transport, site size and outdoor facilities can be addressed through a detailed design process.
5. If a new school in Kirkliston is not deliverable, then we will extend Queensferry High School – by far the least popular option in Kirkliston and in Queensferry.
6. We believe it would work and would be very successful.

Proposal

Outline

- Establish a new 600 capacity secondary school on the site of the existing Kirkliston Leisure Centre;
- Catchment area formed from the existing Kirkliston Primary School catchment area;
- New school's catchment area implemented from November prior to new school opening;
- Kirkliston Primary School as feeder school to the new high school;
- Catchment boundary of Queensferry High School changed to exclude catchment area of Kirkliston Primary School;
- New school built with capacity for 600 pupils extendable to 1,200 if required.



Proposal

How would it work?

- Whole community engagement through design and planning.
- Flexible design to accommodate expansion to 1,200 pupils at a later stage.
- Community access as a core principle developed with users through design process.
- Designed to Passivhaus standards.
- Head Teacher appointed well in advance of opening in August 2028.
- School would open in August 2028 with S1 pupils only - each consecutive year a new year group would be added (same approach as Winchburgh Academy).
- Sibling guarantee in place so siblings not at different schools.

Proposal

Next Steps

- Statutory Consultation:
 - Until Tuesday 31 October 2023
- Education Scotland Report
- Outcome of Consultation Report:
 - Council meeting in January 2024



www.edinburgh.gov.uk/kirklistonhs



Q&A Session

Small School Sites

- Proposed site is 1.7 Ha
- School site sizes governed by the **Schools Premises Regulations, 1967 as amended.**
- Regulations separate out size of area required for school building and size of area for pitches.
- Pitches do not have to be located on the school site.
- **600** pupils requires site of **2.0 Ha**; **1,200** requires site of **2.6 Ha** (excludes pitches)
- A smaller site area can be provided for a new school with the consent of the Scottish Government.
- **13 out of 23** secondary schools in Edinburgh **do not** comply with 1967 site size regulations.

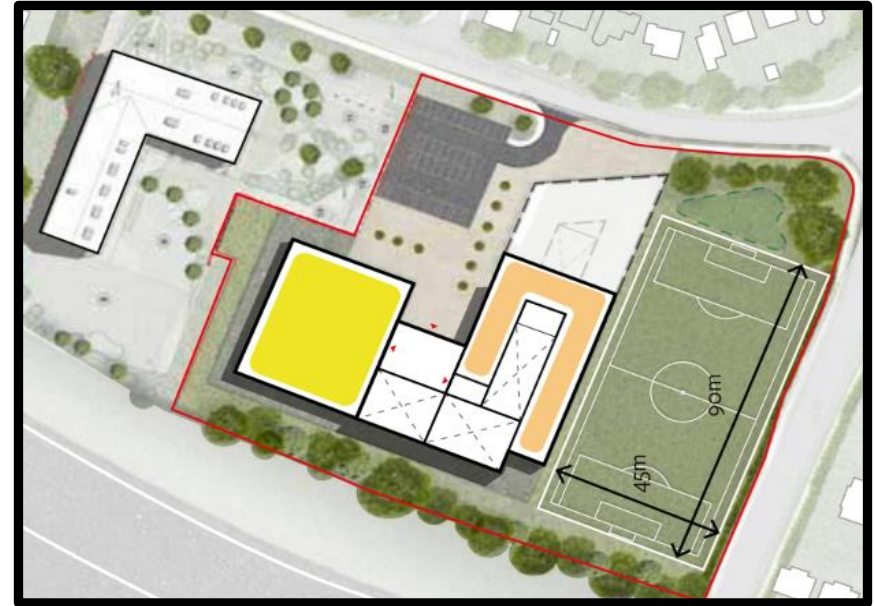

Small School Sites

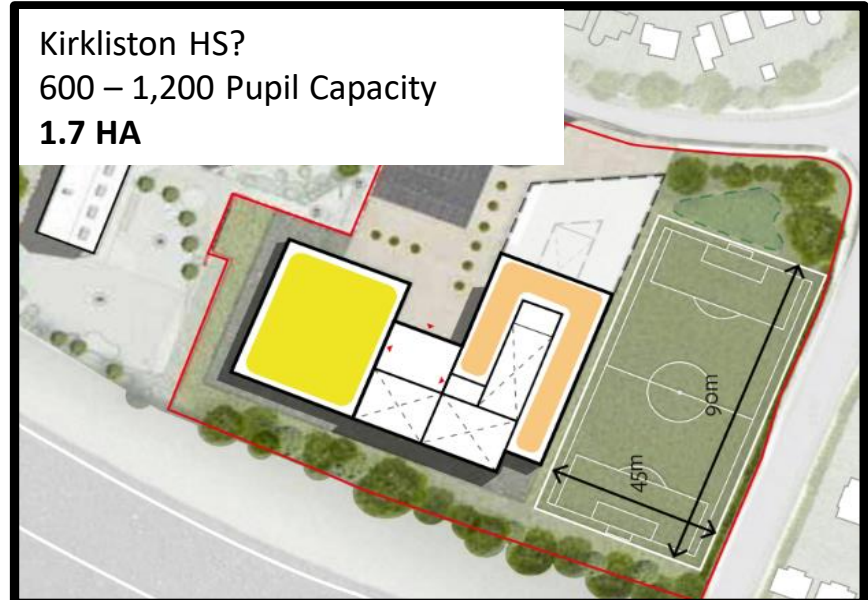
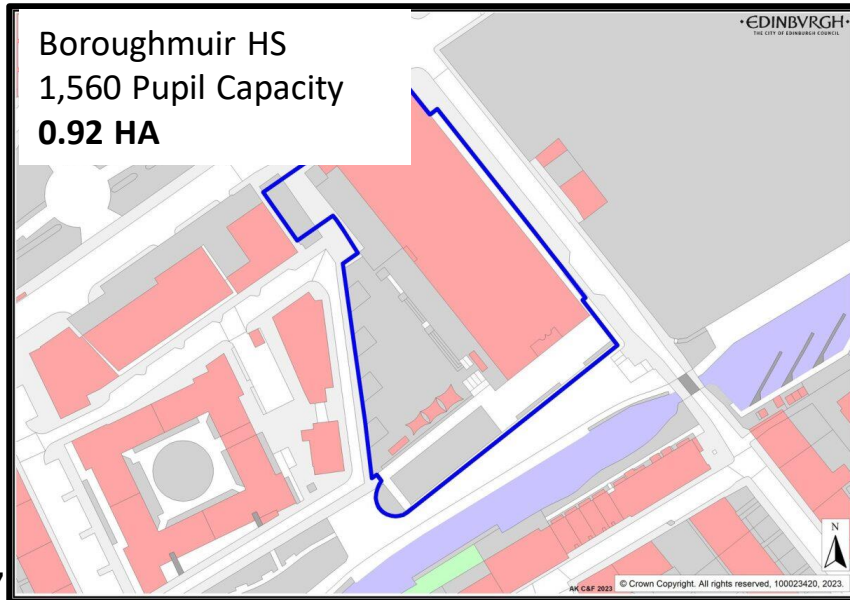
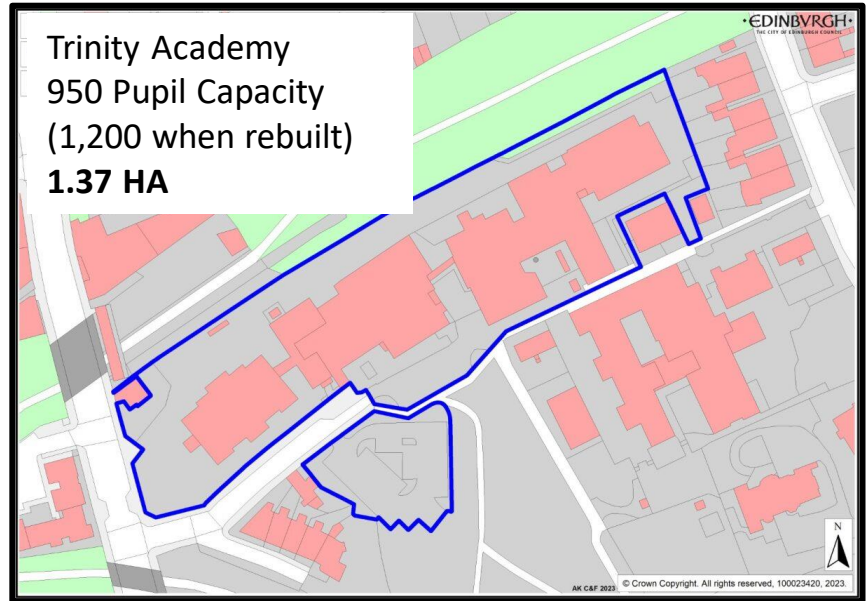
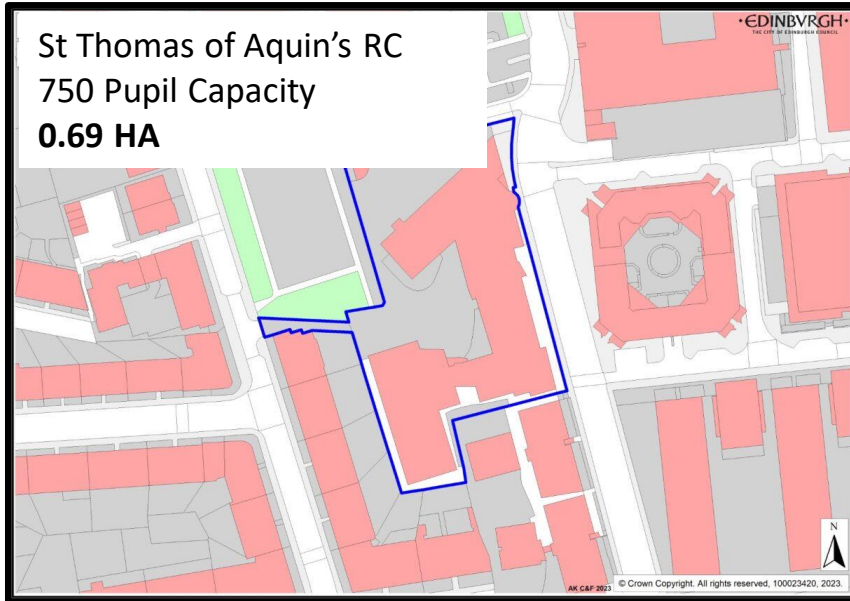

Planning Issues

Kirkliston Community High School - Alternative Sites

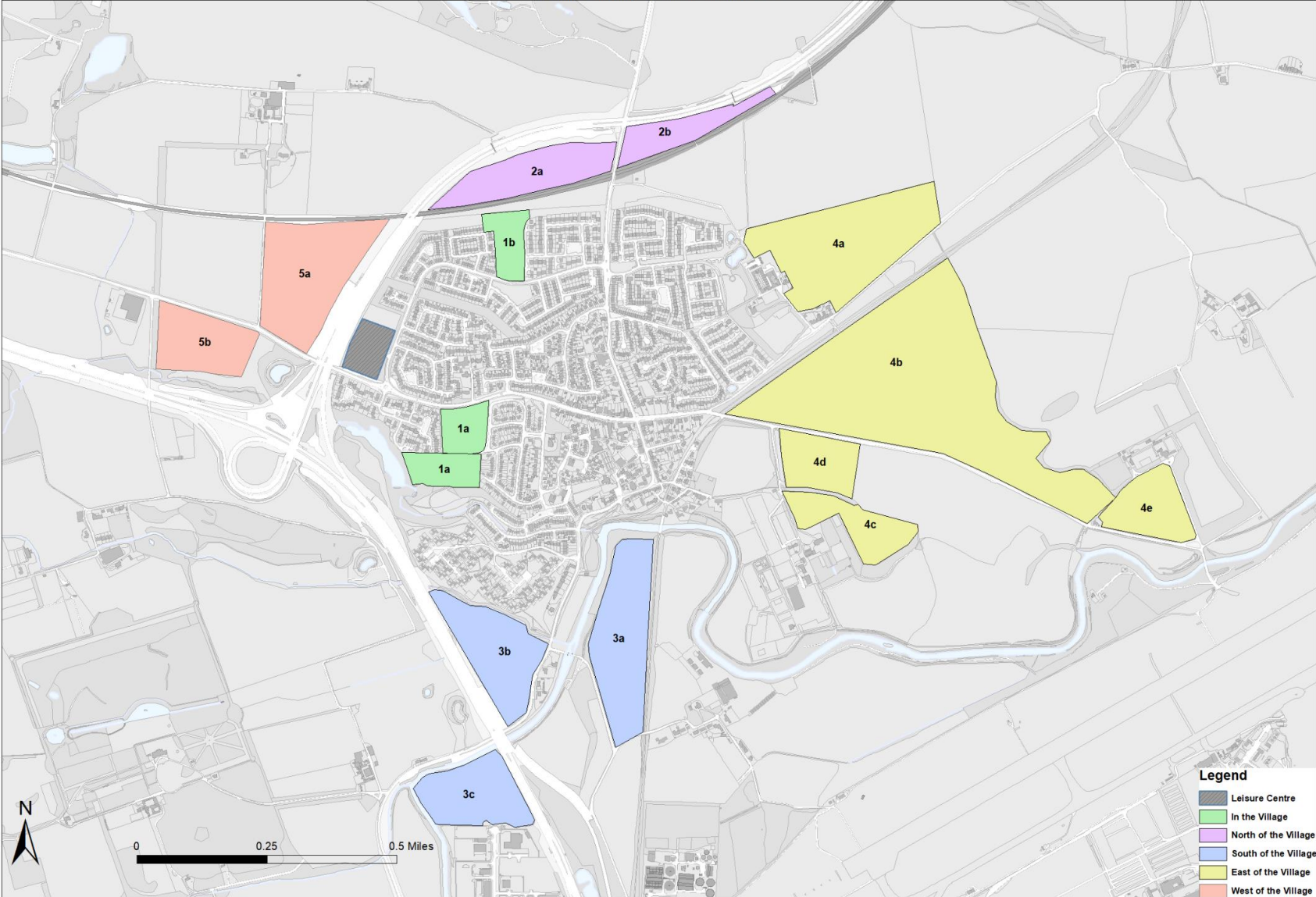

Greenbelt Status

- A Local Development Plan (**LDP**) sets out policies and proposals to manage where development should take place.
- Current LDP adopted in 2016.
- New LDP – City Plan 2030 – consulted on in 2020. (Choices for City Plan).
- Approved by Council in November 2022.
- Scottish Government Examination began December 2022.
- Developers made representations supporting release of land around Kirkliston.
- Hearing held September 2023.
- Scottish Government report to be published early 2024.
- CEC believe that it is **highly unlikely** that any changes to City Plan 2030 affecting Kirkliston will be required.

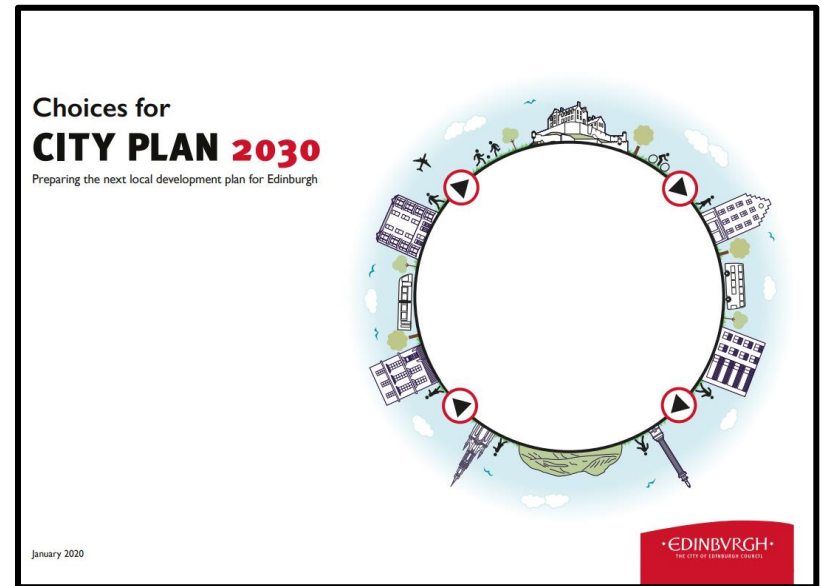

Choices

“The allocation of this site for housing, if required, would give the Council an opportunity to secure a site in Kirkliston for a new secondary school as well as significant financial contributions from developers for its delivery.”

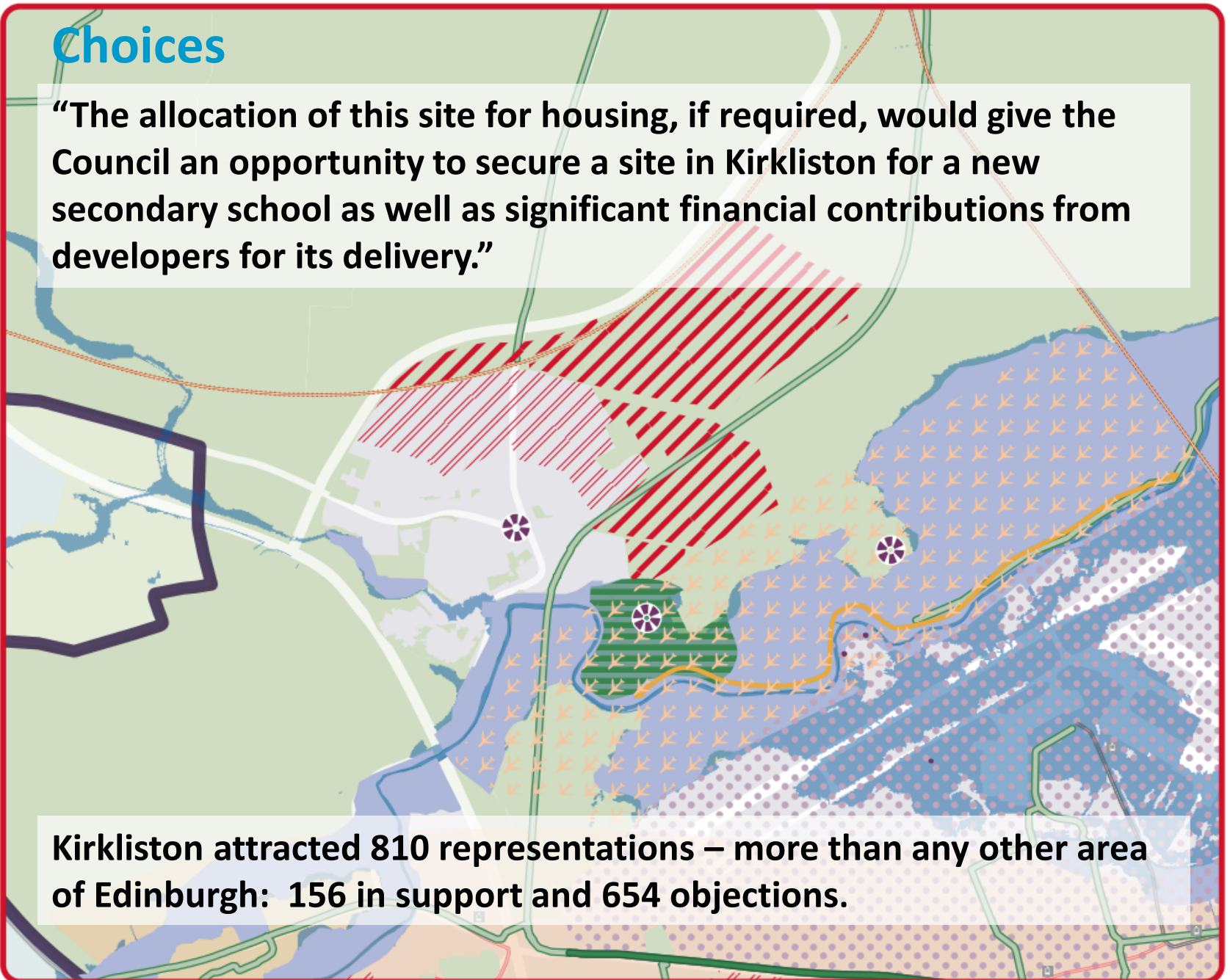

Kirkliston attracted 810 representations – more than any other area of Edinburgh: 156 in support and 654 objections.

Greenbelt Status

National Planning Framework 4

- New National Planning Framework published by Scottish Government in February 2023 sets national planning policy.
- All authorities to produce new LDP reflecting NPF4 by May 2028
- NPF4 Policy does support essential infrastructure in the green belt...but definition of “essential infrastructure” does not include schools.
- Development of Greenspace under the next LDP appears more difficult under NPF4 as it seeks to protect land around towns and cities.

Planning Conclusions

- Development of a school on greenbelt is contrary to National and local policy.
- There may be potential to locate pitches on some Greenbelt sites.
- Greenbelt sites could be released for development in 5 years time...
- ...however, Kirkliston overwhelmingly rejected this in 2020 and the new National Planning Framework makes this release less likely.

Educational Benefits – Vision and Values

- At the heart of the successful introduction of a new Kirkliston Secondary will be a clear vision for the new school. The vision, values and aims will be developed with stakeholders, with children and young people, parents/carers and staff actively involved.
- Success will be driven through leadership of the school at all levels and the establishment of a positive culture and ethos.
- With a supported, creative and ambitious approach and working in partnership with stakeholders, a smaller school community - as is proposed at Kirkliston - can thrive equally as well as a larger one.

Educational Benefits – Curriculum

- An exciting opportunity to review the curriculum, to challenge traditional structures and methods for learning and introduce innovative practice, aligned with the recommendations and outcomes of the Hayward Review.
- The curriculum offer and the totality of the curriculum experience is best defined by the ability of the school to meet the needs of its learners and this isn't an ability exclusive to larger schools. Leadership and partnerships are crucial in this respect.
- Engagement of creative teaching and learning approaches in a new viable and sustainable school space can broaden scope for attainment and achievement.

Educational Benefits – Digital

- New technologies will be fully utilised, supporting and enabling Edinburgh's 1:1 Empowered Digital Learning Strategy.
- The development of equity of opportunity through digital technology will provide even greater access to learning and courses; locally, nationally and internationally through distance and hybrid learning activities.

Educational Benefits – Transitions

- Enhanced transitions into, between and beyond each stage of education will ensure continuity and progression to support pupil well-being and raising of attainment.
- Transition activity will be planned collaboratively, with staff, learners, parents and partners actively involved in decision making as we develop a new Kirkliston High School. This will include co-creation of the physical design of accommodation and facilities as well as the design of the Curriculum.
- Planning for transition will provide staff, learners, families and the community significant opportunities for meaningful engagement with the process, developing a sense of ownership of their new learning environment.

Further Information and Online Questionnaire

www.edinburgh.gov.uk/kirklistonhs

kirklistonhs@edinburgh.gov.uk

Thank you for your time

