

DRG. NO.

# INFRASTRUCTURE

DRG. NO.

## EXISTING

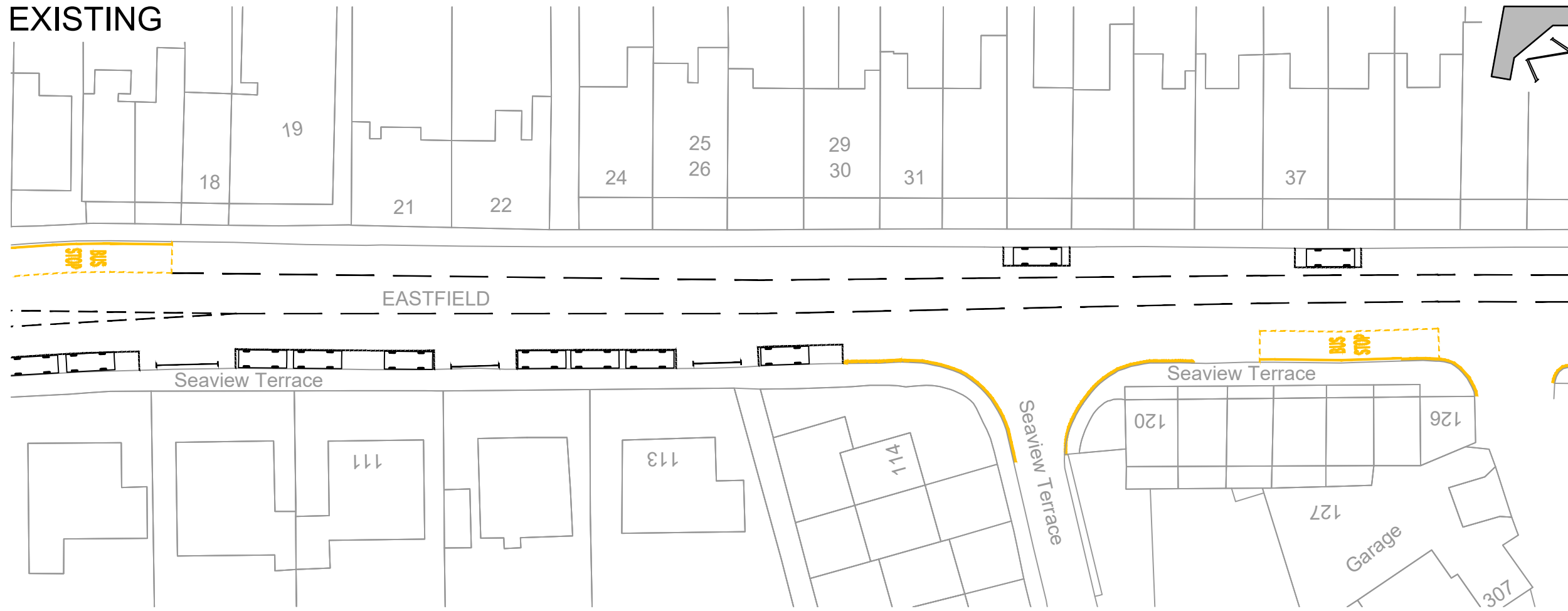

NOTES:  
 Proposed Scheme to provide up to xNo. Bikes  
 Amendment to existing CPZ TRO under sections 35, 35 & 63 of the RTRA 1984.

## PROPOSED

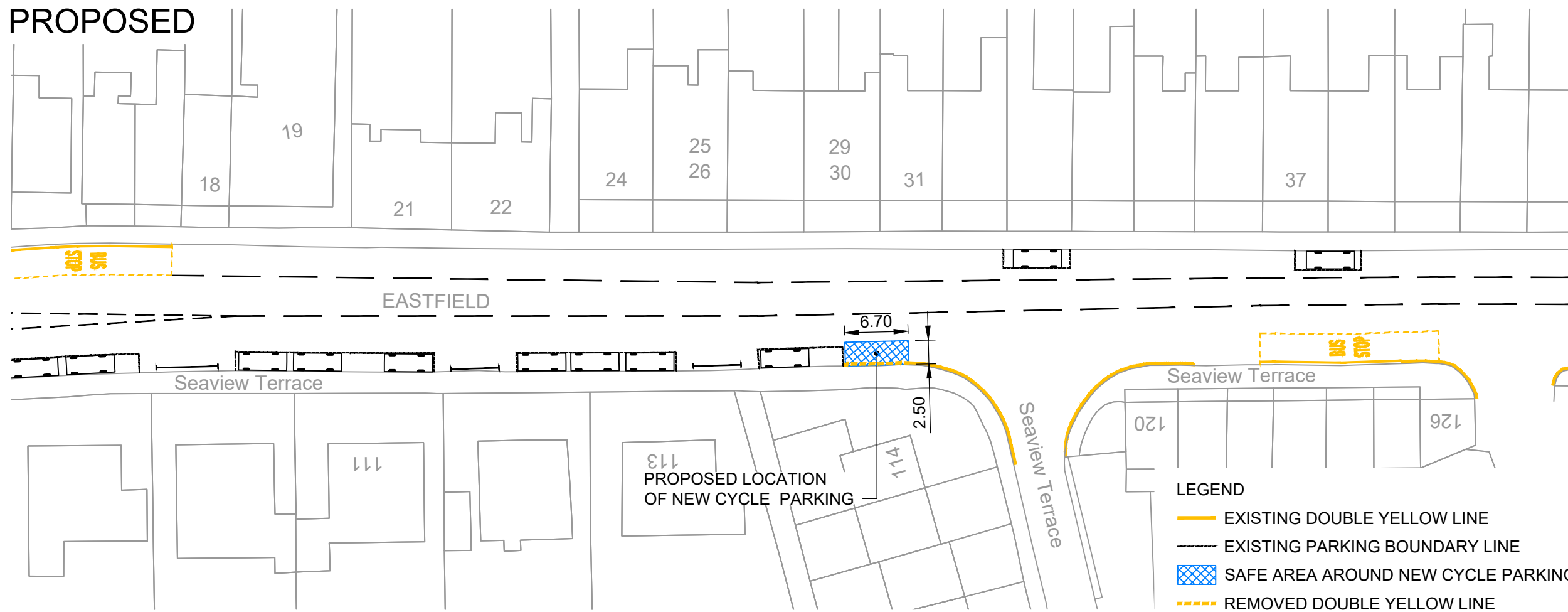

This map is reproduced from Ordnance Survey material with the permission of Ordnance Survey on behalf of the Controller of Her Majesty's Stationery Office © Crown copyright. Unauthorised reproduction infringes Crown copyright and may lead to prosecution or civil proceedings.  
 100023420 (2018)

DRG. NO.

Drawing Name: F:\projects\Traffic - CEC Secure Cycle Parking\04 CAD\20-Sheets\00X\_TRO\_0005 - Eastfield (Joppa).dwg  
 Xref: F:\projects\Traffic - CEC Secure Cycle Parking\04 CAD\10-References\REF-C-Visiting-Restrictions  
 Xref: I:\0-References\REF-C-OS BASE\_EASTFIELD  
 Xref: I:\0-Models\MOD-C-EASTFIELD

REV	DETAILS	BY	DATE	CHECK



The City of Edinburgh Council  
 Waverley Court  
 4 East Market Street  
 Edinburgh, EH8 8BG  
 Telephone: 0131 200 2000

PLACE  
 PLANNING AND TRANSPORT  
 INFRASTRUCTURE  
 TRANSPORT DESIGN & DELIVERY

Secure On-Street Cycle Parking Scheme  
 Eastfield (Joppa)

Date: NOV 2018  
 Scale: 1:500  
 Job No.  
 Drawn by: AJS  
 Checked by: TH  
 Reviewed by: TH

DRG. NO. XX\_TRO\_0005