

DRG. NO.

INFRASTRUCTURE

DRG. NO.

EXISTING

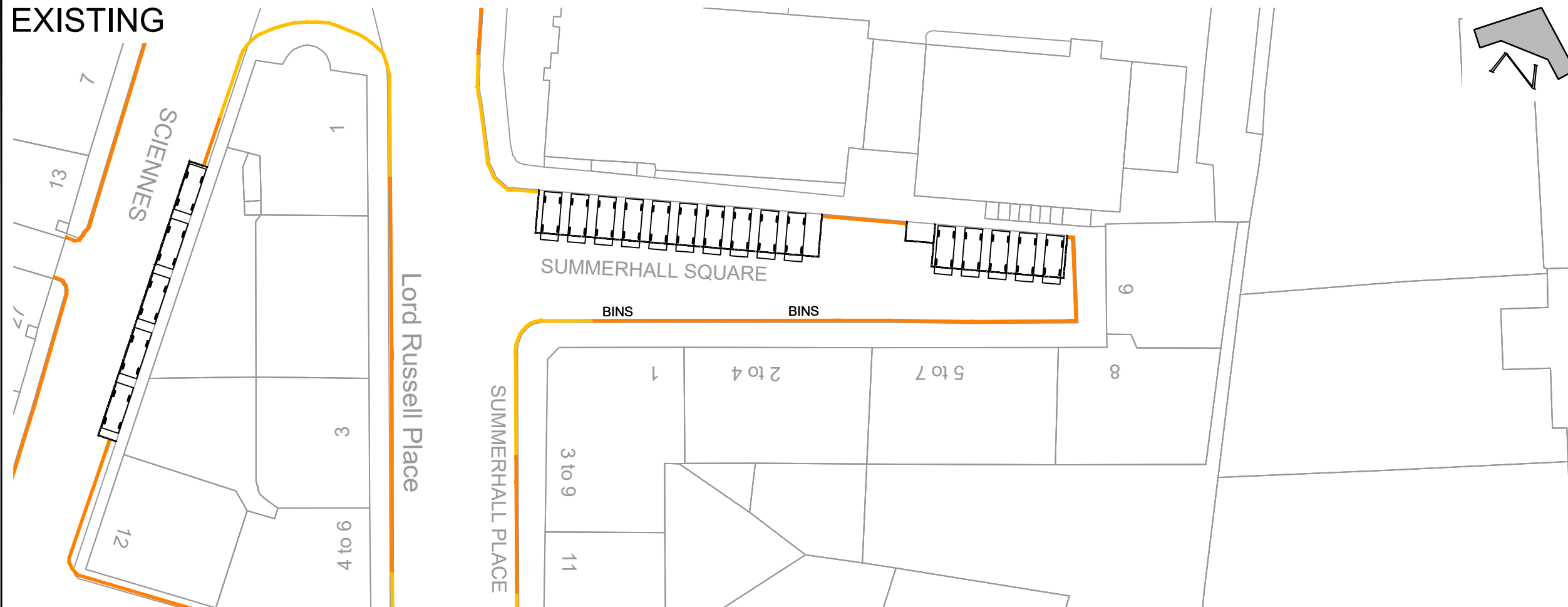

NOTES:

Proposed Scheme to provide up to xNo. Bikes

Amendment to existing CPZ TRO under sections 35, 35 & 63 of the RTRA 1984.

PROPOSED

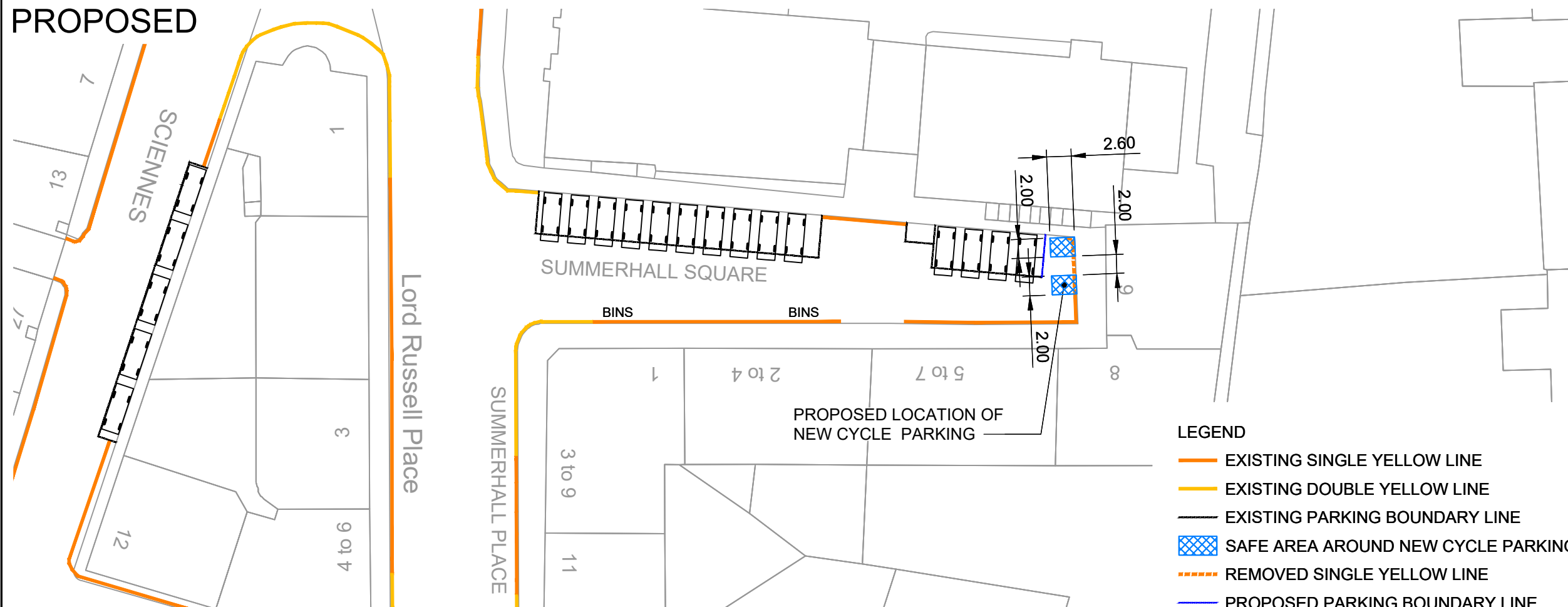

This map is reproduced from Ordnance Survey material with the permission of Ordnance Survey on behalf of the Controller of Her Majesty's Stationery Office © Crown copyright. Unauthorised reproduction infringes Crown copyright and may lead to prosecution or civil proceedings.

100023420 (2018)

REV	DETAILS	BY	DATE	CHECK

• EDINBURGH •

THE CITY OF EDINBURGH COUNCIL

The City of Edinburgh Council
Waverley Court
4 East Market Street
Edinburgh, EH8 8BG
Telephone: 0131 200 2000

PLACE
PLANNING AND TRANSPORT
INFRASTRUCTURE
TRANSPORT DESIGN & DELIVERY

Secure On-Street Cycle Parking Scheme Summerhall Square

Date: JAN 2019
Scale: 1:500

Job No.
Checked by: TH
Reviewed by: TH

Drawn by: AJS

DRG. NO.

Drawing Name: F:\projects\Traffic - CEC Secure Cycle Parking\04 CAD\20-Sheets\XX_TRO_0049 - Summerhall Square.dwg
 Xref: F:\projects\Traffic - CEC Secure Cycle Parking\04 CAD\10-References\REF-C-Visiting-Restrictions
 Xref: 05-Models\MOD-C-SUMMERHALL-SQUARE
 Xref: 110-References\REF-C-03 BASE_SUMMERHALL-SQUARE

DRG. NO. XX_TRO_0049