

N

PROJECT

CEC WALK & CYCLE ROUTES - WP1

CLIENT

EDINBURGH  
THE CITY OF EDINBURGH COUNCIL

CONSULTANT

AECOM  
1 Tanfield  
EDINBURGH, EH3 5DA  
+44 (0) 131 301 8600 tel  
+44 (0) 131 301 8699 fax  
www.aecom.com

NOTES

1. ALL WORKS TO BE EXECUTED IN ACCORDANCE WITH THE SPECIFICATION FOR HIGHWAY WORKS - THE MANUAL OF CONTRACT DOCUMENTS FOR HIGHWAY WORKS, DESIGN MANUAL FOR ROADS AND BRIDGES, TRAFFIC SIGNS MANUAL AND LOCAL COUNCIL GUIDELINES.

2. ALL DIMENSIONS ARE IN METRES UNLESS STATED OTHERWISE. ALL LEVELS ARE IN METRES AND RELATE TO ORDNANCE DATUM.

3. DO NOT SCALE FROM ANY DRAWING. WORK TO FIGURED DIMENSIONS ONLY. ANY DISCREPANCIES IN DIMENSION ARE TO BE REFERRED TO THE DESIGNER BEFORE WORK IS PUT TO HAND.

4. ALL DIMENSIONS AND LEVELS ARE TO BE CHECKED ON SITE BY THE CONTRACTOR PRIOR TO PREPARING ANY WORKING DRAWINGS OR COMMENCING ON SITE.

5. ALL WORKS BY THE CONTRACTOR MUST BE CARRIED OUT IN SUCH A WAY THAT ALL REQUIREMENTS UNDER THE HEALTH AND SAFETY AT WORK ACT ARE SATISFIED.

6. ALL WORK IS TO BE CARRIED OUT IN COMPLIANCE WITH THE REQUIREMENTS OF THE STATUTORY AUTHORITIES AND CONSTRUCTION DESIGN AND MANAGEMENT REGULATIONS.

7. DRAWING BASE RECEIVED FROM OTHERS, SURVEY CARRIED OUT BY OTHERS, AECOM CANNOT GUARANTEE THEIR ACCURACY. CONTRACTOR TO SATISFY THEMSELVES AS TO THE ACCURACY OF SUCH INFORMATION.

ISSUE/REVISION

2	31/01/17	CONSTRUCTION ISSUE
1	09/01/17	TENDER ISSUE
I/R	DATE	DESCRIPTION

PROJECT NUMBER

60487449

SHEET TITLE

5.4 NORTH EDINBURGH PATH NETWORK - WEST GRANTON ACCESS CYCLEWAY

SHEET NUMBER

60487449-SKE-C-WP1-5.4-0001

This drawing has been prepared for the use of AECOM's client. It may not be used, modified, reproduced or relied upon by third parties, except as agreed by AECOM or as required by law. AECOM accepts no responsibility, and denies any liability, whatsoever, to any party that uses or relies on this drawing without AECOM's express written consent. Do not scale this document. All measurements must be obtained from the stated dimensions.



- KEY
- EXISTING PAVING SLABS TO BE REMOVED
  - FLUSH KERBS TO BE LIFTED AND SET ASIDE FOR REUSE

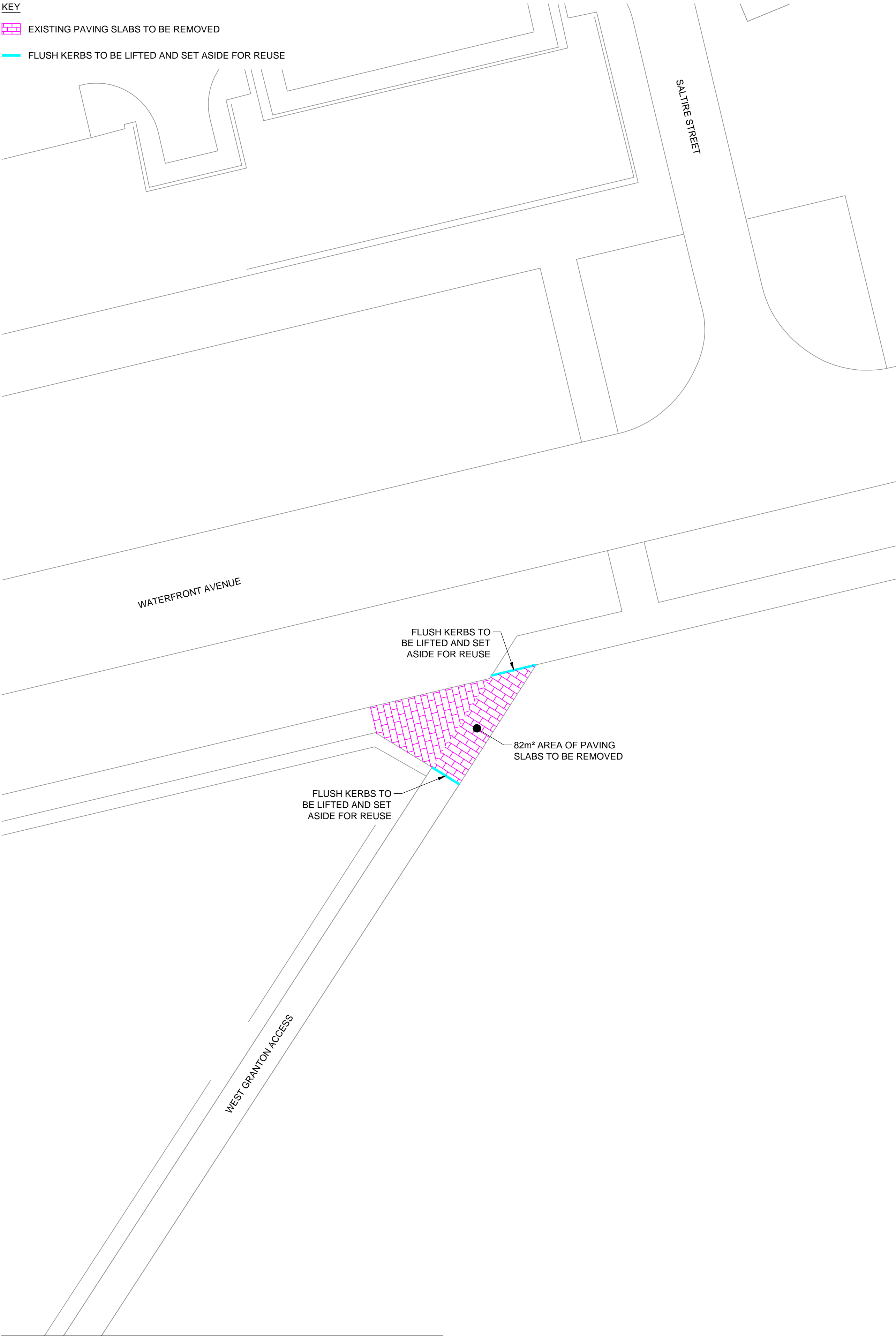

RESIDUAL HAZARDS IDENTIFIED	
ITEM	DESCRIPTION
1	REFER TO SAFETY IN DESIGN - DESIGNER'S RESIDUAL HAZARDS REGISTER FOR HAZARDS IN RELATION TO THESE WORKS

Site Clearance

- KEY
- CYCLEWAY CONSTRUCTION (FULL DEPTH)
  - FLUSH KERBS TO BE RELAID
  - NEW DRAINAGE GULLY

NOTES

1. REFER TO DRAWING 60487449-SKE-C-WP1-5.4-0003 FOR STANDARD DETAILS

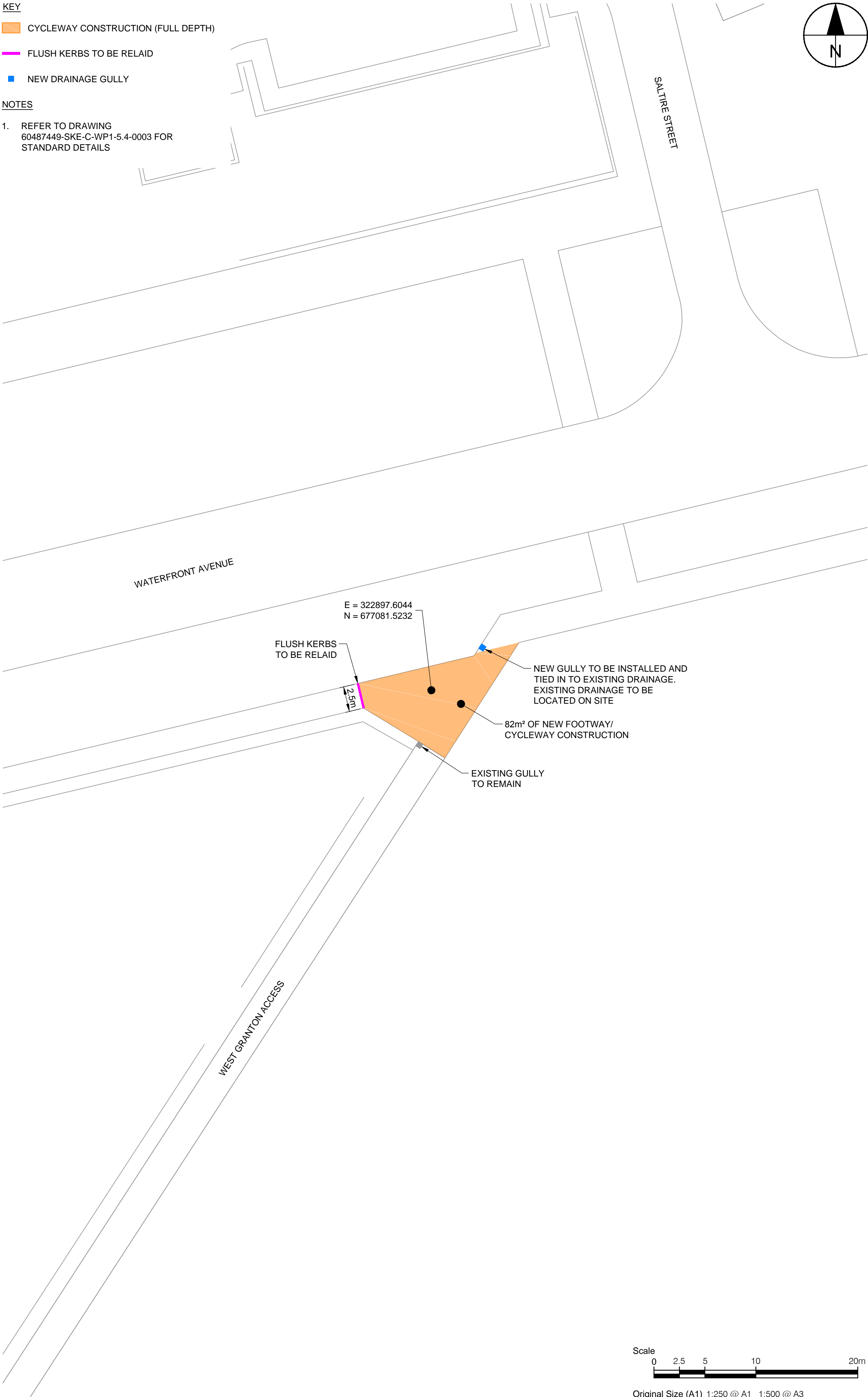

General Arrangement

This drawing has been prepared for the use of AECOM's client. It may not be used, modified, reproduced or relied upon by third parties, except as agreed by AECOM or as required by law. AECOM accepts no responsibility, and denies any liability, whatsoever, to any party that uses or relies on this drawing without AECOM's express written consent. All measurements must be obtained from the stated dimensions.



PROJECT

CEC WALK & CYCLE ROUTES - WP1

CLIENT



CONSULTANT

AECOM  
1 Tanfield  
EDINBURGH, EH3 5DA  
+44 (0) 131 301 8600 tel  
+44 (0) 131 301 8699 fax  
www.aecom.com

NOTES

- ALL WORKS TO BE EXECUTED IN ACCORDANCE WITH THE SPECIFICATION FOR HIGHWAY WORKS - THE MANUAL OF CONTRACT DOCUMENTS FOR HIGHWAY WORKS, DESIGN MANUAL FOR ROADS AND BRIDGES, TRAFFIC SIGNS MANUAL AND LOCAL COUNCIL GUIDELINES.
- ALL DIMENSIONS ARE IN METRES UNLESS STATED OTHERWISE. ALL LEVELS ARE IN METRES AND RELATE TO ORDNANCE DATUM.
- DO NOT SCALE FROM ANY DRAWING. WORK TO FIGURED DIMENSIONS ONLY. ANY DISCREPANCIES IN DIMENSION ARE TO BE REFERRED TO THE DESIGNER BEFORE WORK IS PUT TO HAND.
- ALL DIMENSIONS AND LEVELS ARE TO BE CHECKED ON SITE BY THE CONTRACTOR PRIOR TO PREPARING ANY WORKING DRAWINGS OR COMMENCING ON SITE.
- ALL WORKS BY THE CONTRACTOR MUST BE CARRIED OUT IN SUCH A WAY THAT ALL REQUIREMENTS UNDER THE HEALTH AND SAFETY AT WORK ACT ARE SATISFIED.
- ALL WORK IS TO BE CARRIED OUT IN COMPLIANCE WITH THE REQUIREMENTS OF THE STATUTORY AUTHORITIES AND CONSTRUCTION DESIGN AND MANAGEMENT REGULATIONS.
- DRAWING BASE RECEIVED FROM OTHERS. SURVEY CARRIED OUT BY OTHERS. AECOM CANNOT GUARANTEE THEIR ACCURACY. CONTRACTOR TO SATISFY THEMSELVES AS TO THE ACCURACY OF SUCH INFORMATION.

ISSUE/REVISION

2	31/01/17	CONSTRUCTION ISSUE
1	09/01/17	TENDER ISSUE
I/R	DATE	DESCRIPTION

PROJECT NUMBER

60487449

SHEET TITLE

5.4 NORTH EDINBURGH PATH NETWORK - WEST GRANTON ACCESS CYCLEWAY

SHEET NUMBER

60487449-SKE-C-WP1-5.4-0002

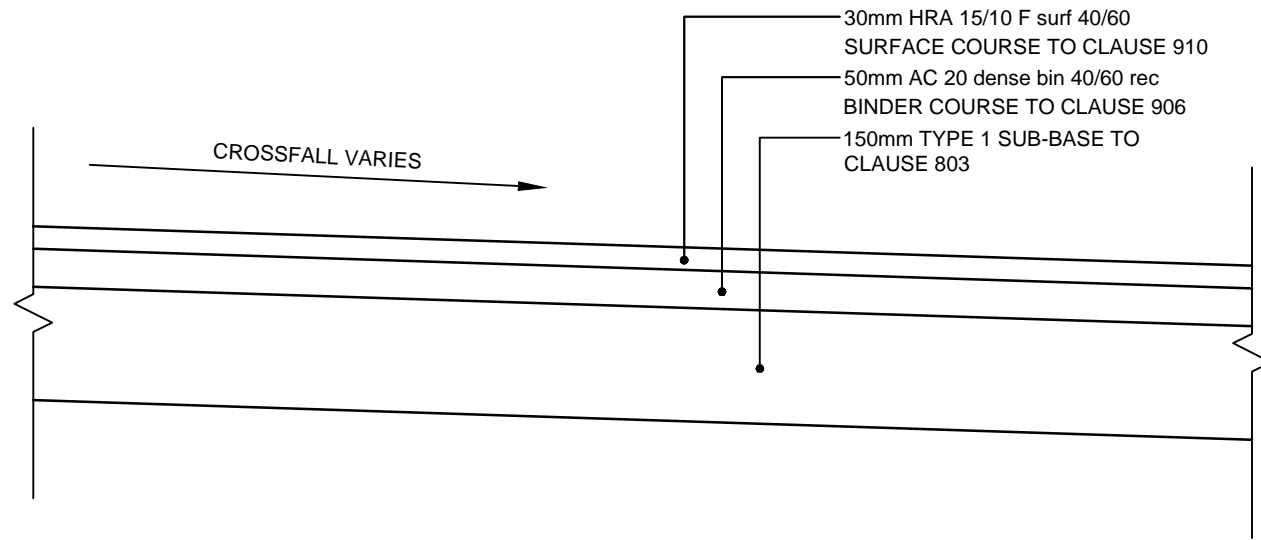

CYCLEWAY CONSTRUCTION - FULL DEPTH

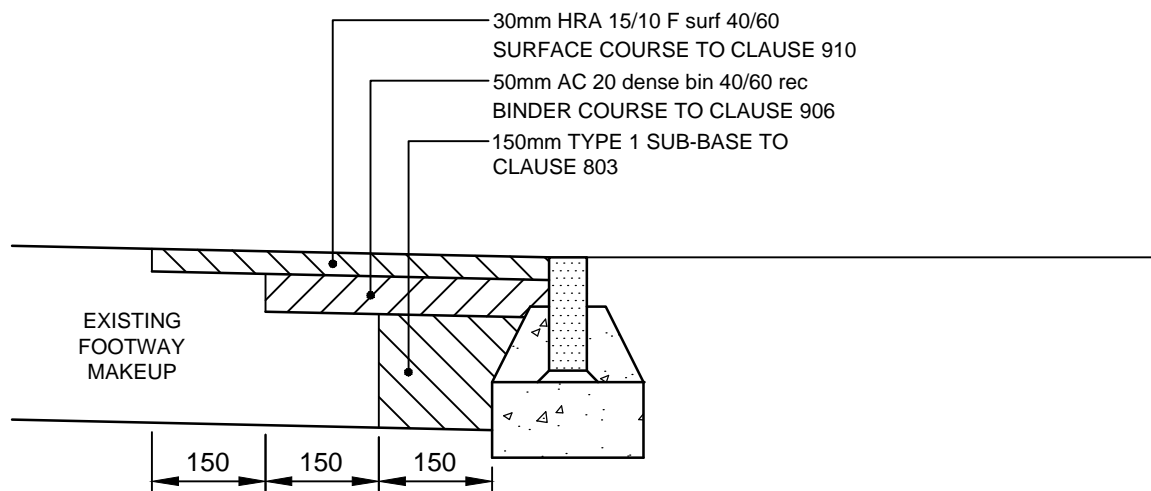

REINSTATEMENT OF FOOTWAY

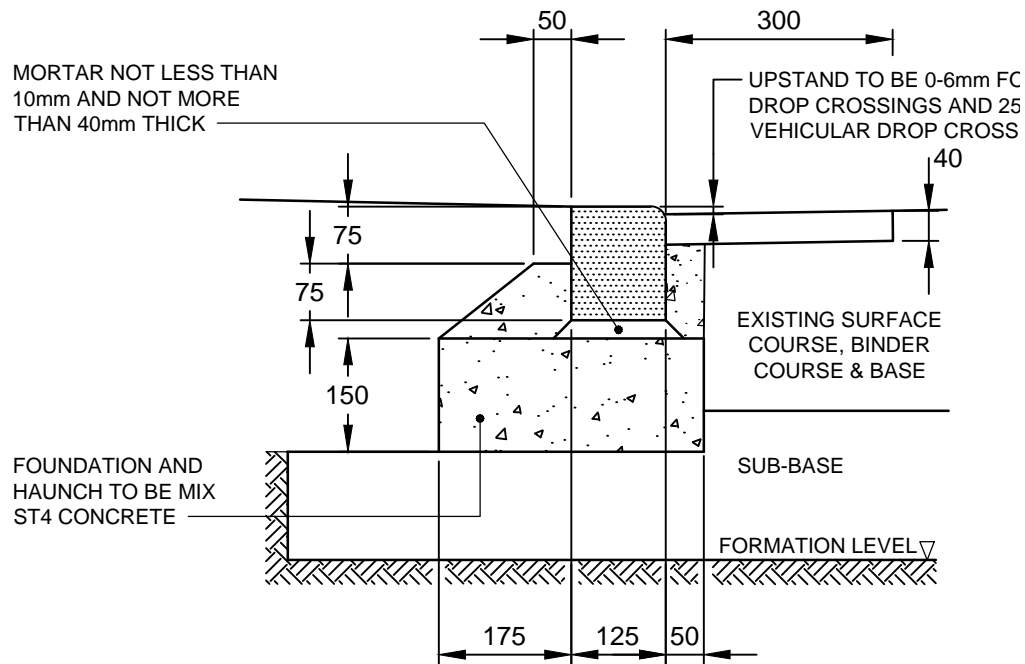

PRECAST CONCRETE ROAD KERB  
125 x 150mm BULLNOSE PATTERN

PROJECT

CEC WALK & CYCLE  
ROUTES - WP1

CLIENT



CONSULTANT

AECOM  
1 Tanfield  
EDINBURGH, EH3 5DA  
+44 (0) 131 301 8600 tel  
+44 (0) 131 301 8699 fax  
www.aecom.com

NOTES

1. ALL WORKS TO BE EXECUTED IN ACCORDANCE WITH THE SPECIFICATION FOR HIGHWAY WORKS - THE MANUAL OF CONTRACT DOCUMENTS FOR HIGHWAY WORKS, DESIGN MANUAL FOR ROADS AND BRIDGES, TRAFFIC SIGNS MANUAL AND LOCAL COUNCIL GUIDELINES.
2. ALL DIMENSIONS ARE IN METRES UNLESS STATED OTHERWISE. ALL LEVELS ARE IN METRES AND RELATE TO ORDNANCE DATUM.
3. DO NOT SCALE FROM ANY DRAWING. WORK TO FIGURED DIMENSIONS ONLY. ANY DISCREPANCIES IN DIMENSION ARE TO BE REFERRED TO THE DESIGNER BEFORE WORK IS PUT TO HAND.
4. ALL DIMENSIONS AND LEVELS ARE TO BE CHECKED ON SITE BY THE CONTRACTOR PRIOR TO PREPARING ANY WORKING DRAWINGS OR COMMENCING ON SITE.
5. ALL WORKS BY THE CONTRACTOR MUST BE CARRIED OUT IN SUCH A WAY THAT ALL REQUIREMENTS UNDER THE HEALTH AND SAFETY AT WORK ACT ARE SATISFIED.
6. ALL WORK IS TO BE CARRIED OUT IN COMPLIANCE WITH THE REQUIREMENTS OF THE STATUTORY AUTHORITIES AND CONSTRUCTION DESIGN AND MANAGEMENT REGULATIONS.
7. DRAWING BASE RECEIVED FROM OTHERS, SURVEY CARRIED OUT BY OTHERS. AECOM CANNOT GUARANTEE THEIR ACCURACY. CONTRACTOR TO SATISFY THEMSELVES AS TO THE ACCURACY OF SUCH INFORMATION.

ISSUE/REVISION

2	31/01/17	CONSTRUCTION ISSUE
1	09/01/17	TENDER ISSUE
I/R	DATE	DESCRIPTION

KEY PLAN

PROJECT NUMBER

60487449

SHEET TITLE

5.4 NORTH EDINBURGH PATH  
NETWORK - W. GRANTON ACCESS  
CONSTRUCTION DETAILS

SHEET NUMBER

60487449-SKE-C-WP1-5.4-0003

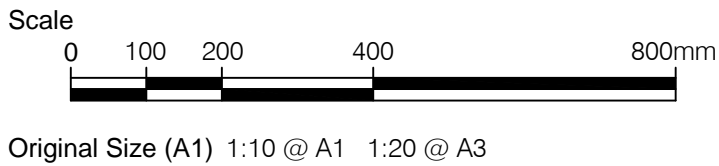

This drawing has been prepared for the use of AECOM's client. It may not be used, modified, reproduced or relied upon by third parties, except as agreed by AECOM or as required by law. AECOM accepts no responsibility, and denies any liability, whatsoever, to any party that uses or relies on this drawing without AECOM's express written consent. All measurements must be obtained from the stated dimensions.



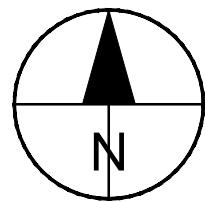
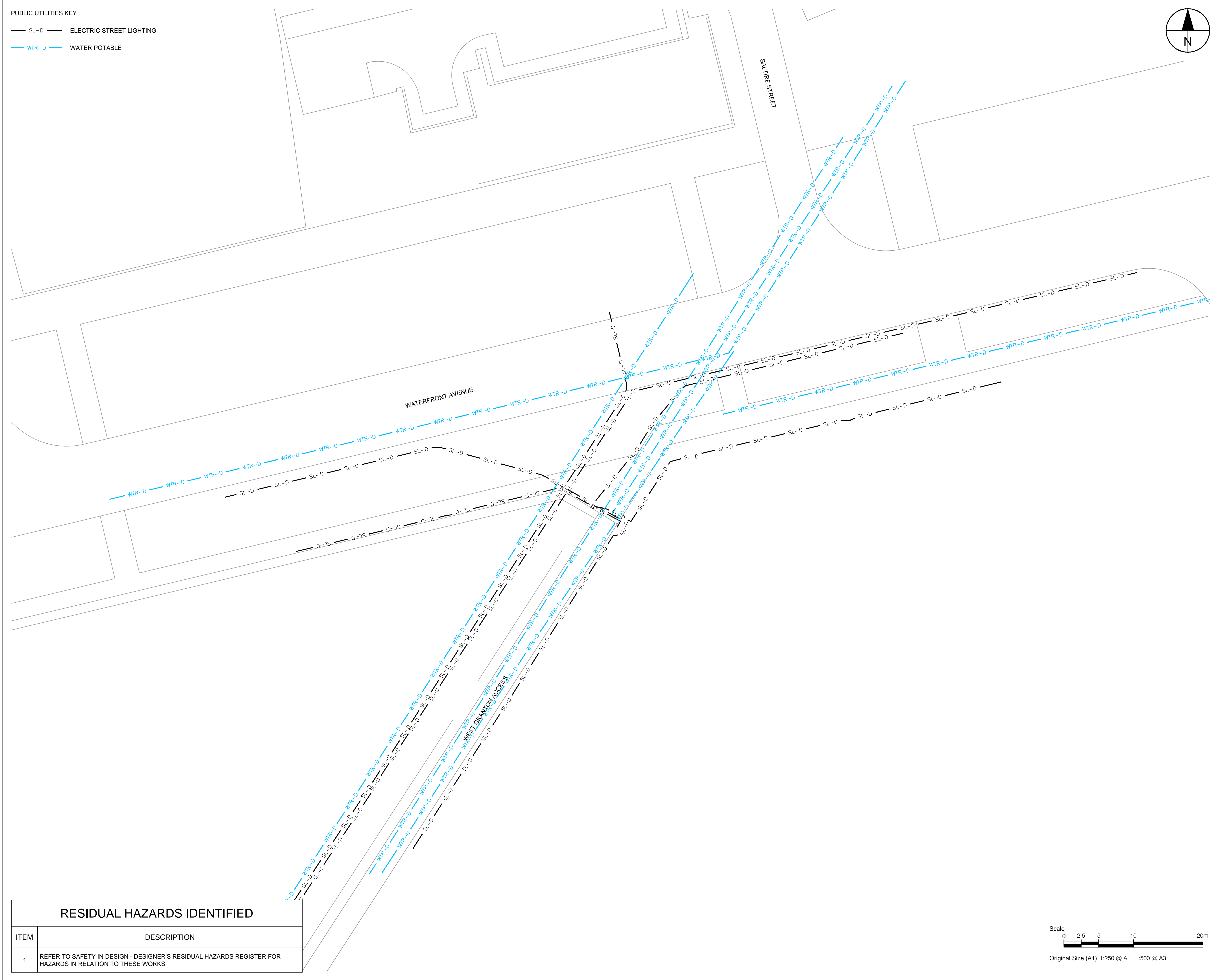

This drawing has been prepared for the use of AECOM's client. It may not be used, modified, reproduced or relied upon by third parties, except as agreed by AECOM or as required by law. AECOM accepts no responsibility, and denies any liability, whatsoever, to any party that uses or relies on this drawing without AECOM's express written consent. All measurements must be obtained from the stated dimensions.

**AECOM**

**PROJECT**

**CEC WALK & CYCLE  
ROUTES - WP1**

**CLIENT**

**EDINBURGH**  
THE CITY OF EDINBURGH COUNCIL

**CONSULTANT**

AECOM  
1 Tanfield  
EDINBURGH, EH3 5DA  
+44 (0) 131 301 8600 tel  
+44 (0) 131 301 8699 fax  
www.aecom.com

**NOTES**

1. ALL WORKS TO BE EXECUTED IN ACCORDANCE WITH THE SPECIFICATION FOR HIGHWAY WORKS - THE MANUAL OF CONTRACT DOCUMENTS FOR HIGHWAY WORKS, DESIGN MANUAL FOR ROADS AND BRIDGES, TRAFFIC SIGNS MANUAL AND LOCAL COUNCIL GUIDELINES.
2. ALL DIMENSIONS ARE IN METRES UNLESS STATED OTHERWISE. ALL LEVELS ARE IN METRES AND RELATE TO ORDNANCE DATUM.
3. DO NOT SCALE FROM ANY DRAWING. WORK TO FIGURED DIMENSIONS ONLY. ANY DISCREPANCIES IN DIMENSION ARE TO BE REFERRED TO THE DESIGNER BEFORE WORK IS PUT TO HAND.
4. ALL DIMENSIONS AND LEVELS ARE TO BE CHECKED ON SITE BY THE CONTRACTOR PRIOR TO PREPARING ANY WORKING DRAWINGS OR COMMENCING ON SITE.
5. ALL WORKS BY THE CONTRACTOR MUST BE CARRIED OUT IN SUCH A WAY THAT ALL REQUIREMENTS UNDER THE HEALTH AND SAFETY AT WORK ACT ARE SATISFIED.
6. ALL WORK IS TO BE CARRIED OUT IN COMPLIANCE WITH THE REQUIREMENTS OF THE STATUTORY AUTHORITIES AND CONSTRUCTION DESIGN AND MANAGEMENT REGULATIONS.
7. DRAWING BASE RECEIVED FROM OTHERS. SURVEY CARRIED OUT BY OTHERS. AECOM CANNOT GUARANTEE THEIR ACCURACY. CONTRACTOR TO SATISFY THEMSELVES AS TO THE ACCURACY OF SUCH INFORMATION.

**ISSUE/REVISION**

2	31/01/17	CONSTRUCTION ISSUE
1	09/01/17	TENDER ISSUE
I/R	DATE	DESCRIPTION

**PROJECT NUMBER**

60487449

**SHEET TITLE**

5.4 NORTH EDINBURGH PATH  
NETWORK - WEST GRANTON ACCESS  
PUBLIC UTILITIES

**SHEET NUMBER**

60487449-SKE-C-WP1-5.4-0202

