

- KEY: SERIES 0105 - GENERAL ARRANGEMENT
- FOOTWAY / SPLITTER ISLAND
  - CARRIAGEWAY
  - RAISED TABLE
  - SHARED USE SURFACING
  - SEGREGATED CYCLE FACILITY
  - LANDSCAPING
  - UNCONTROLLED TACTILE PAVING (GREY)
  - CONTROLLED TACTILE PAVING (GREY)
  - CORDUROY TACTILE PAVING (GREY)
  - PROPOSED KERB
  - PROPOSED EDGING KERB
  - FENCING
  - EXISTING / PROPOSED TREE
  - STREET FURNITURE

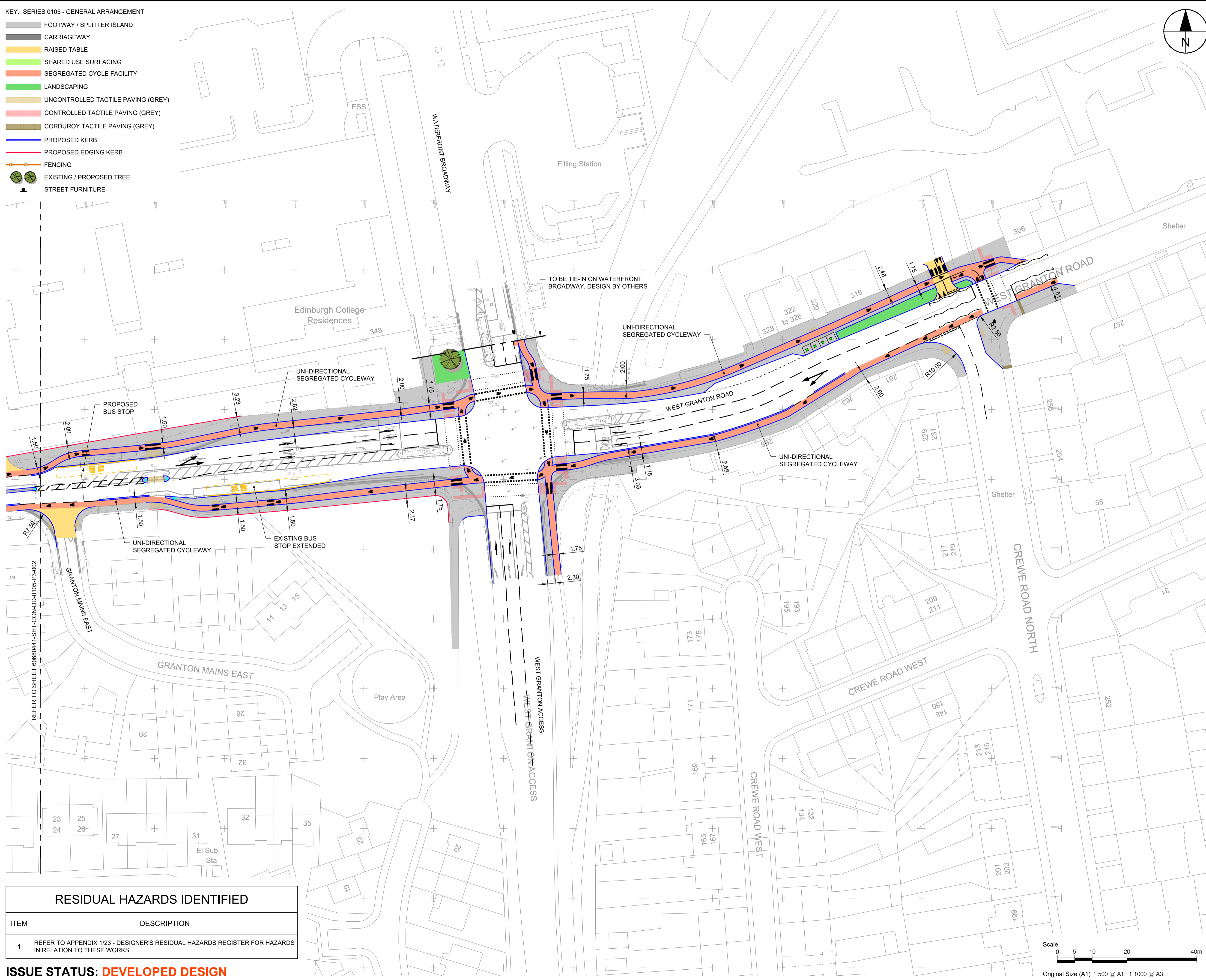

**AECOM**

PROJECT  
**NORTH EDINBURGH CONNECTIONS**

North Edinburgh Connections

CLIENT  
**EDINBURGH**  
THE CITY OF EDINBURGH COUNCIL

CONSULTANT  
AECOM  
1 Tanfield  
EDINBURGH, EH3 5DA  
+44 (0) 131 301 8600 tel  
+44 (0) 131 301 8699 fax  
www.aecom.com

- NOTES
1. ALL DIMENSIONS ARE IN METRES UNLESS STATED OTHERWISE. ALL LEVELS ARE IN METRES AND RELATE TO ORDNANCE DATUM.
  2. DO NOT SCALE FROM ANY DRAWING. WORK TO FIGURED DIMENSIONS ONLY.
  3. ALL WORKS BY THE CONTRACTOR MUST BE CARRIED OUT IN SUCH A WAY THAT ALL REQUIREMENTS UNDER THE HEALTH AND SAFETY AT WORK ACT ARE SATISFIED.
  4. ALL WORK IS TO BE CARRIED OUT IN COMPLIANCE WITH THE REQUIREMENTS OF THE STATUTORY AUTHORITIES AND CONSTRUCTION DESIGN AND MANAGEMENT REGULATIONS.

ISSUE/REVISION

I/R	DATE	DESCRIPTION

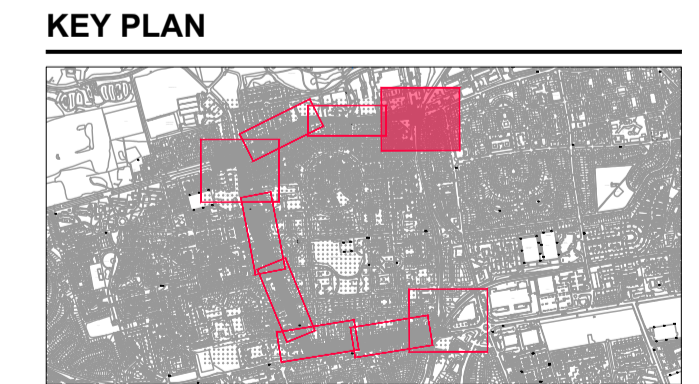

PROJECT NUMBER  
60680441

SHEET TITLE  
GENERAL ARRANGEMENT  
SHEET 1 OF 6

SHEET NUMBER  
60680441-SHT-CON-DD-0105-P3-001

RESIDUAL HAZARDS IDENTIFIED

ITEM	DESCRIPTION
1	REFER TO APPENDIX 1/23 - DESIGNER'S RESIDUAL HAZARDS REGISTER FOR HAZARDS IN RELATION TO THESE WORKS

ISSUE STATUS: **DEVELOPED DESIGN**

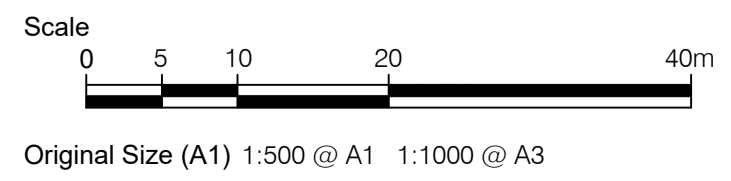

File name: \\A:\AECOM\NET\COM\1\FSE\ME\EDINBURGH\UK\ED14\DCS\PROJECTS\CIC\60680441\_NEA\_T\_CONNECTIONS\900\_CAD\_GIS\910\_CAD20-SHEETS\DEVELOPED DESIGN  
 2026060441-SHT-CON-DD-0105-P3-001\0006 - GENERAL ARRANGEMENT.DWG  
 Last saved by: SWANSONAJ Last Plotter: 2026-05-16

ISO A1 594mm x 841mm  
 Approved: \_\_\_\_\_  
 Checked: \_\_\_\_\_  
 Designer: \_\_\_\_\_  
 Project Management Initials: \_\_\_\_\_

This drawing has been prepared for the use of AECOM's client. It may not be used, modified, reproduced or relied upon by third parties, except as agreed by AECOM or as required by law. AECOM accepts no responsibility, and denies any liability, whatsoever, to any party that uses or relies on this drawing without AECOM's express written consent. Do not scale this document. All measurements must be obtained from the stated dimensions.

1. ALL DIMENSIONS ARE IN METRES UNLESS STATED OTHERWISE. ALL LEVELS ARE IN METRES AND RELATE TO ORDNANCE DATUM.
2. DO NOT SCALE FROM ANY DRAWING. WORK TO FIGURED DIMENSIONS ONLY.
3. ALL WORKS BY THE CONTRACTOR MUST BE CARRIED OUT IN SUCH A WAY THAT ALL REQUIREMENTS UNDER THE HEALTH AND SAFETY AT WORK ACT ARE SATISFIED.
4. ALL WORK IS TO BE CARRIED OUT IN COMPLIANCE WITH THE REQUIREMENTS OF THE STATUTORY AUTHORITIES AND CONSTRUCTION DESIGN AND MANAGEMENT REGULATIONS.

ISSUE/REVISION

I/R	DATE	DESCRIPTION

KEY PLAN

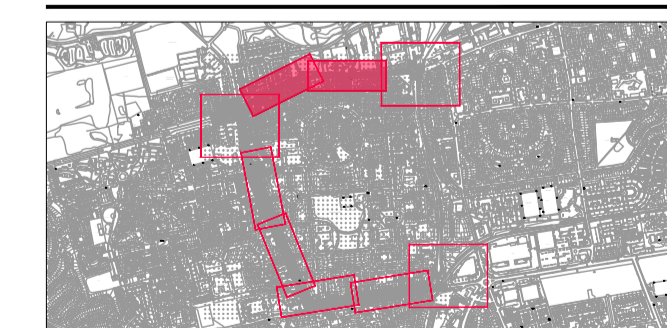

PROJECT NUMBER

60680441

SHEET TITLE

GENERAL ARRANGEMENT  
SHEET 2 OF 6

SHEET NUMBER

60680441-SHT-CON-DD-0105-P3-002

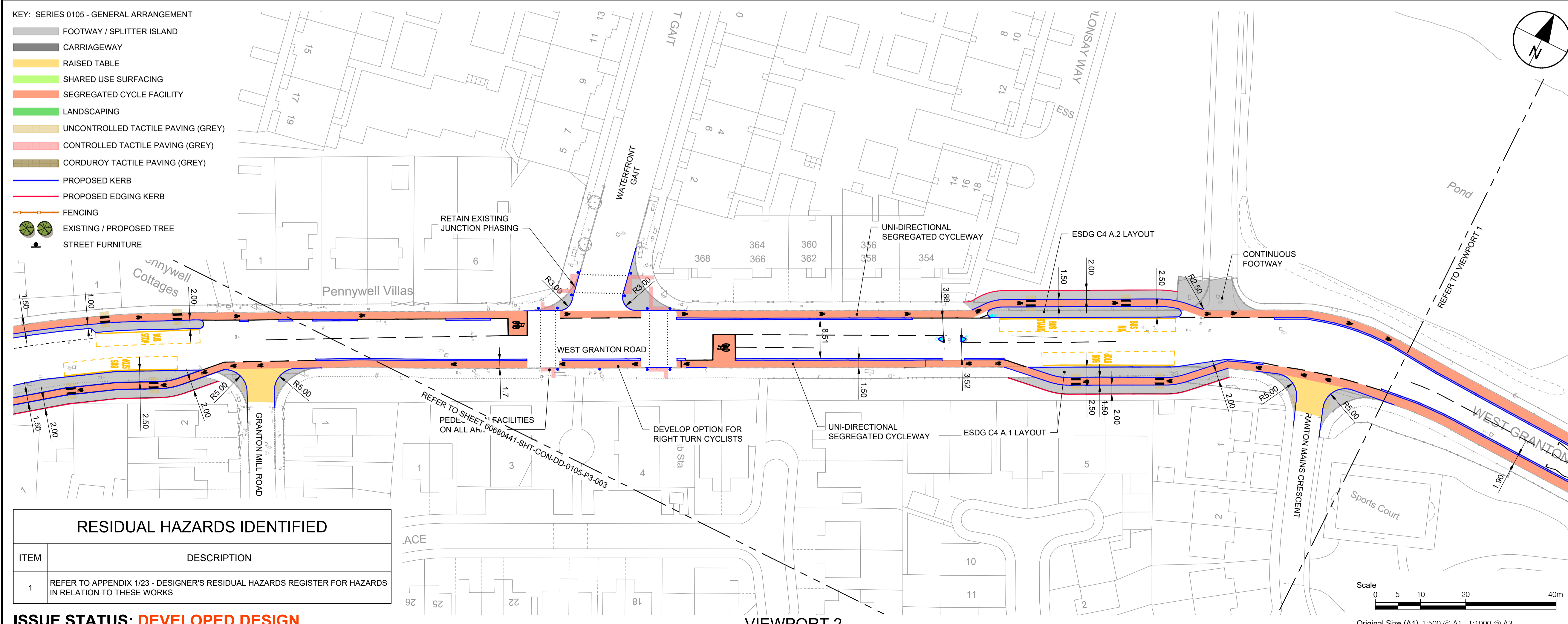
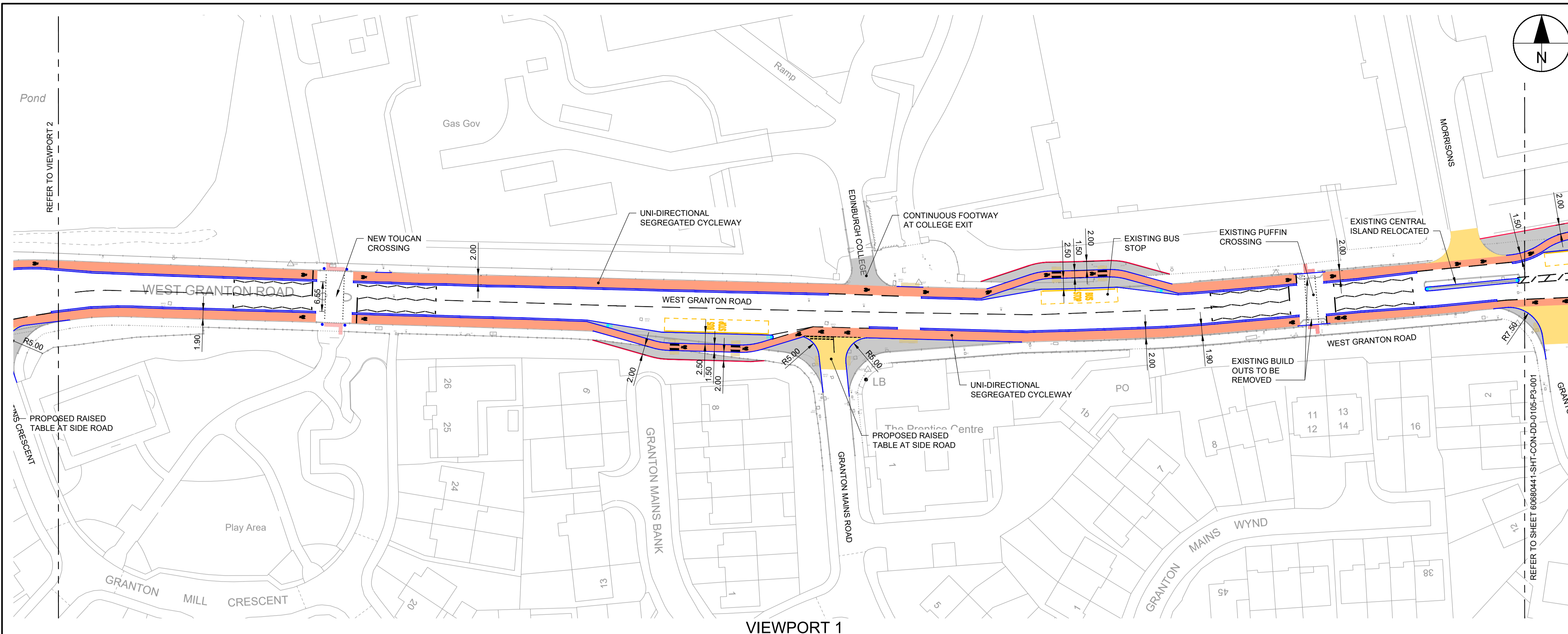

- KEY: SERIES 0105 - GENERAL ARRANGEMENT
- FOOTWAY / SPLITTER ISLAND
  - CARRIAGEWAY
  - RAISED TABLE
  - SHARED USE SURFACING
  - SEGREGATED CYCLE FACILITY
  - LANDSCAPING
  - UNCONTROLLED TACTILE PAVING (GREY)
  - CONTROLLED TACTILE PAVING (GREY)
  - CORDUROY TACTILE PAVING (GREY)
  - PROPOSED KERB
  - PROPOSED EDGING KERB
  - FENCING
  - EXISTING / PROPOSED TREE
  - STREET FURNITURE

**RESIDUAL HAZARDS IDENTIFIED**

ITEM	DESCRIPTION
1	REFER TO APPENDIX 1/23 - DESIGNER'S RESIDUAL HAZARDS REGISTER FOR HAZARDS IN RELATION TO THESE WORKS

ISSUE STATUS: **DEVELOPED DESIGN**

File name: \\AECOM\NET\COM\1\FSE\ME\EDINBURGH\UK\ED14\DCS\PROJECTS\C160680441\_NEA\_T\_CONNECTIONS\900\_CAD\_GIS\910\_CAD20-SHEETS\DEVELOPED DESIGN  
 2026060441-SHT-CON-DD-0105-P3-001\T0006 - GENERAL ARRANGEMENT.DWG  
 Last saved by: SWANSONAJ Last Plotter: 2026-05-16

File name: \\WA.AECOM\NET\COM\1\5\EMEA\EDINBURGH\UK\ED14\DCS\PROJECTS\C106080441\_NEAT\_CONNECTIONS\900\_CAD\_GIS\910\_CAD20-SHEETS\DEVELOPED DESIGN  
 2026080441-SHT-CON-DD-0105-P3-003 - GENERAL ARRANGEMENT.DWG  
 Last saved by: SWANSONAJ Last Plotter: 2026-03-16  
 Project Management Initials: Designer: Checked: Approved: ISO A1 841mm x 841mm

- KEY: SERIES 0105 - GENERAL ARRANGEMENT**
- FOOTWAY / SPLITTER ISLAND
  - CARRIAGEWAY
  - RAISED TABLE
  - SHARED USE SURFACING
  - SEGREGATED CYCLE FACILITY
  - LANDSCAPING
  - UNCONTROLLED TACTILE PAVING (GREY)
  - CONTROLLED TACTILE PAVING (GREY)
  - CORDUROY TACTILE PAVING (GREY)
  - PROPOSED KERB
  - PROPOSED EDGING KERB
  - FENCING
  - EXISTING / PROPOSED TREE
  - STREET FURNITURE

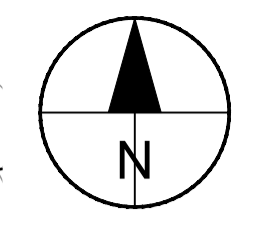
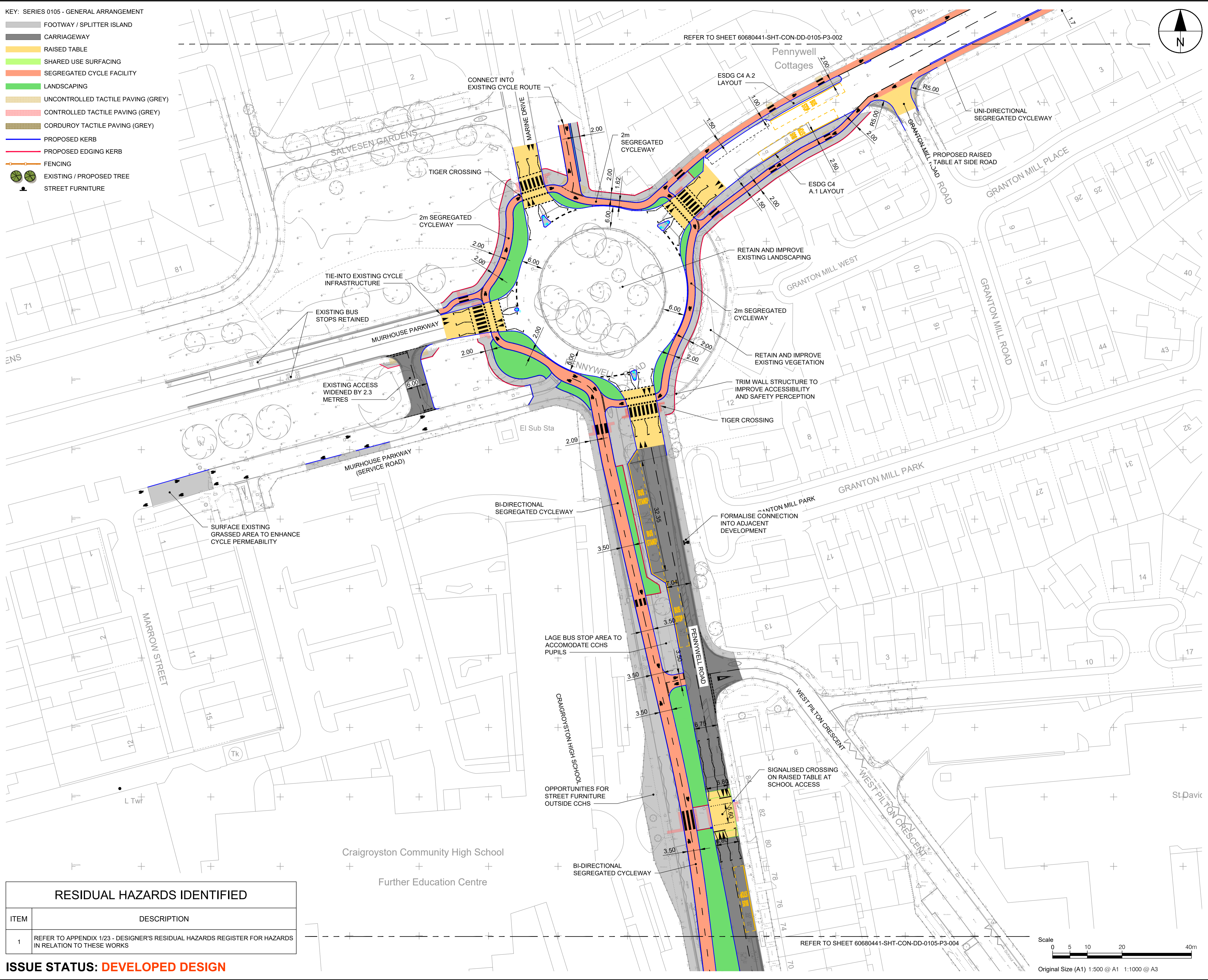

**PROJECT**  
 NORTH EDINBURGH CONNECTIONS



**CLIENT**  
 EDINBURGH THE CITY OF EDINBURGH COUNCIL

**CONSULTANT**  
 AECOM  
 1 Tanfield  
 EDINBURGH, EH3 5DA  
 +44 (0) 131 301 8600 tel  
 +44 (0) 131 301 8699 fax  
 www.aecom.com

**NOTES**

1. ALL DIMENSIONS ARE IN METRES UNLESS STATED OTHERWISE. ALL LEVELS ARE IN METRES AND RELATE TO ORDNANCE DATUM.
2. DO NOT SCALE FROM ANY DRAWING. WORK TO FIGURED DIMENSIONS ONLY.
3. ALL WORKS BY THE CONTRACTOR MUST BE CARRIED OUT IN SUCH A WAY THAT ALL REQUIREMENTS UNDER THE HEALTH AND SAFETY AT WORK ACT ARE SATISFIED.
4. ALL WORK IS TO BE CARRIED OUT IN COMPLIANCE WITH THE REQUIREMENTS OF THE STATUTORY AUTHORITIES AND CONSTRUCTION DESIGN AND MANAGEMENT REGULATIONS.

**ISSUE/REVISION**

I/R	DATE	DESCRIPTION

**KEY PLAN**

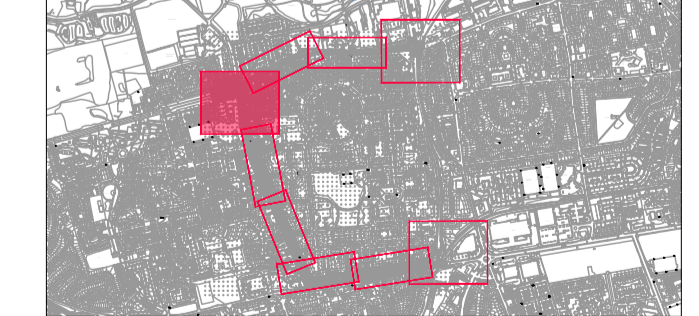

**PROJECT NUMBER**

60680441

**SHEET TITLE**

GENERAL ARRANGEMENT SHEET 3 OF 6

**SHEET NUMBER**

60680441-SHT-CON-DD-0105-P3-003

RESIDUAL HAZARDS IDENTIFIED	
ITEM	DESCRIPTION
1	REFER TO APPENDIX 1/23 - DESIGNER'S RESIDUAL HAZARDS REGISTER FOR HAZARDS IN RELATION TO THESE WORKS

**ISSUE STATUS: DEVELOPED DESIGN**

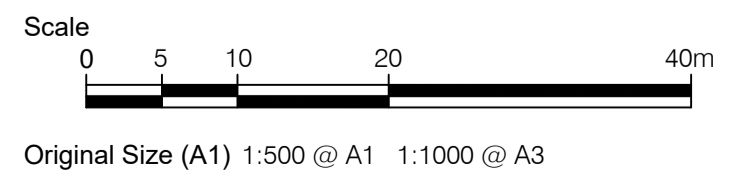

File name: \\AECOM\NET\COM\1\FSE\ME\EDINBURGH\UK\ED\DCS\PROJECTS\C\60680441\_NEA\_T\_CONNECTIONS\900\_CAD\_GIS\910\_CAD20-SHEETS\DEVELOPED DESIGN  
 2026060441-SHT-CON-DD-0105-P3-003-006 - GENERAL ARRANGEMENT.DWG  
 Last saved by: SWANSONA Last Plotter: 2026-03-16  
 ISO A1 841mm x 594mm  
 Project Management Initials: \_\_\_\_\_  
 Designer: \_\_\_\_\_  
 Checked: \_\_\_\_\_  
 Approved: \_\_\_\_\_

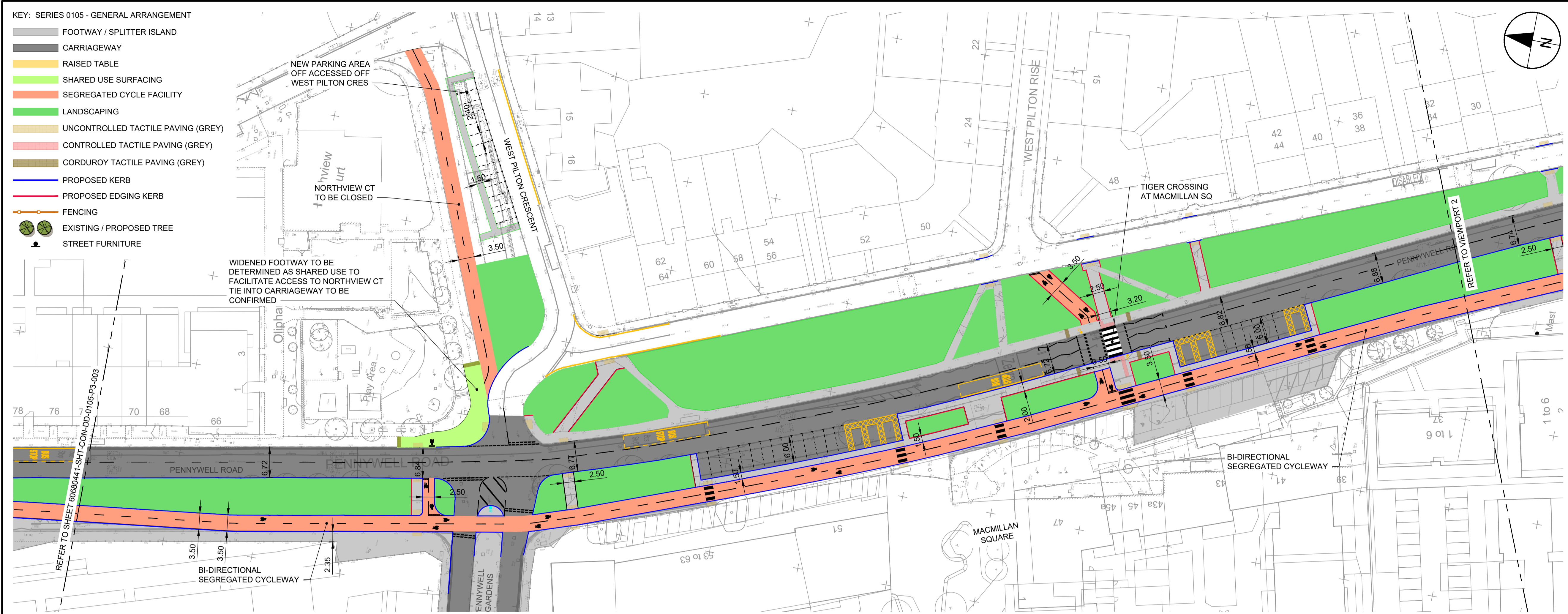

VIEWPORT 1

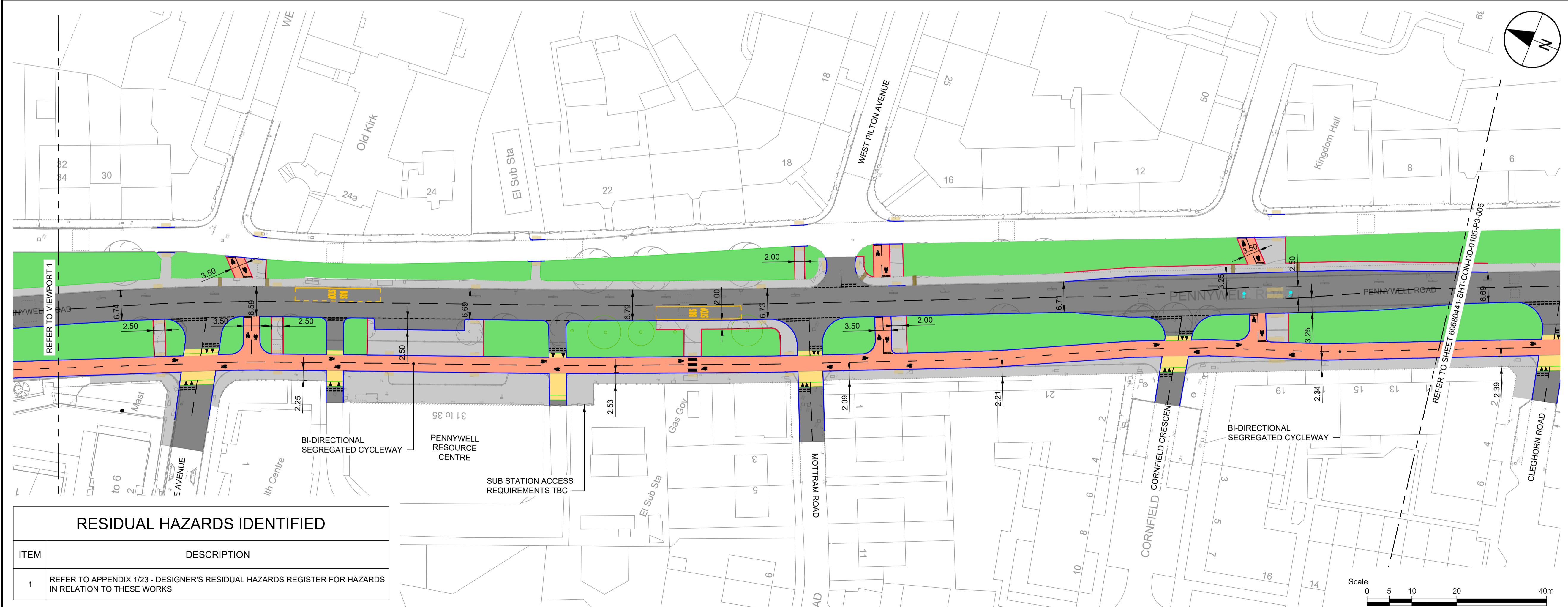

VIEWPORT 2

RESIDUAL HAZARDS IDENTIFIED	
ITEM	DESCRIPTION
1	REFER TO APPENDIX 1/23 - DESIGNER'S RESIDUAL HAZARDS REGISTER FOR HAZARDS IN RELATION TO THESE WORKS

ISSUE STATUS: **DEVELOPED DESIGN**



PROJECT  
**NORTH EDINBURGH CONNECTIONS**



CLIENT  
**EDINBURGH**  
 THE CITY OF EDINBURGH COUNCIL

CONSULTANT  
 AECOM  
 1 Tanfield  
 EDINBURGH, EH3 5DA  
 +44 (0) 131 301 8600 tel  
 +44 (0) 131 301 8699 fax  
 www.aecom.com

- NOTES
- ALL DIMENSIONS ARE IN METRES UNLESS STATED OTHERWISE. ALL LEVELS ARE IN METRES AND RELATE TO ORDNANCE DATUM.
  - DO NOT SCALE FROM ANY DRAWING. WORK TO FIGURED DIMENSIONS ONLY.
  - ALL WORKS BY THE CONTRACTOR MUST BE CARRIED OUT IN SUCH A WAY THAT ALL REQUIREMENTS UNDER THE HEALTH AND SAFETY AT WORK ACT ARE SATISFIED.
  - ALL WORK IS TO BE CARRIED OUT IN COMPLIANCE WITH THE REQUIREMENTS OF THE STATUTORY AUTHORITIES AND CONSTRUCTION DESIGN AND MANAGEMENT REGULATIONS.

ISSUE/REVISION

I/R	DATE	DESCRIPTION

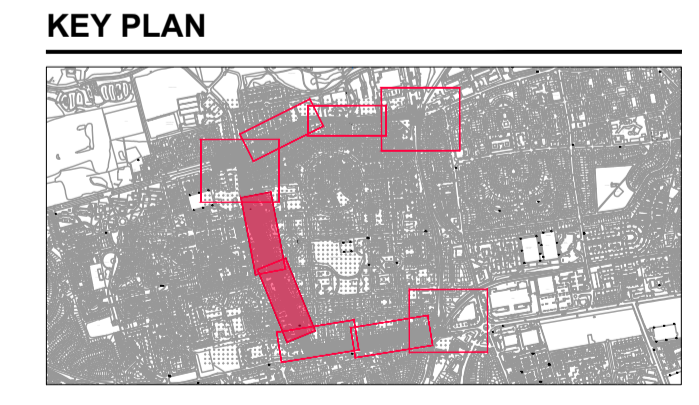

PROJECT NUMBER  
 60680441

SHEET TITLE  
 GENERAL ARRANGEMENT  
 SHEET 4 OF 6

SHEET NUMBER  
 60680441-SHT-CON-DD-0105-P3-004

File name: \\A:\AECOM\NET\COM\1\FSE\EMEA\EDINBURGH\UK\ED4\DCS\PROJECTS\C160680441\_NEAT\_CONNECTIONS\900\_CAD\_GIS\910\_CAD20-SHEETS\DEVELOPED DESIGN  
 2026060441-SHT-CON-DD-0105-P3-001 TO 006 - GENERAL ARRANGEMENT.DWG  
 Last saved by: SWANSONA Last Plotter: 2026-05-16  
 Project Management Initials: Designer: Checked: Approved: ISO A1 994mm x 841mm

- KEY: SERIES 0105 - GENERAL ARRANGEMENT**
- FOOTWAY / SPLITTER ISLAND
  - CARRIAGEWAY
  - RAISED TABLE
  - SHARED USE SURFACING
  - SEGREGATED CYCLE FACILITY
  - LANDSCAPING
  - UNCONTROLLED TACTILE PAVING (GREY)
  - CONTROLLED TACTILE PAVING (GREY)
  - CORDUROY TACTILE PAVING (GREY)
  - PROPOSED KERB
  - PROPOSED EDGING KERB
  - FENCING
  - EXISTING / PROPOSED TREE
  - STREET FURNITURE

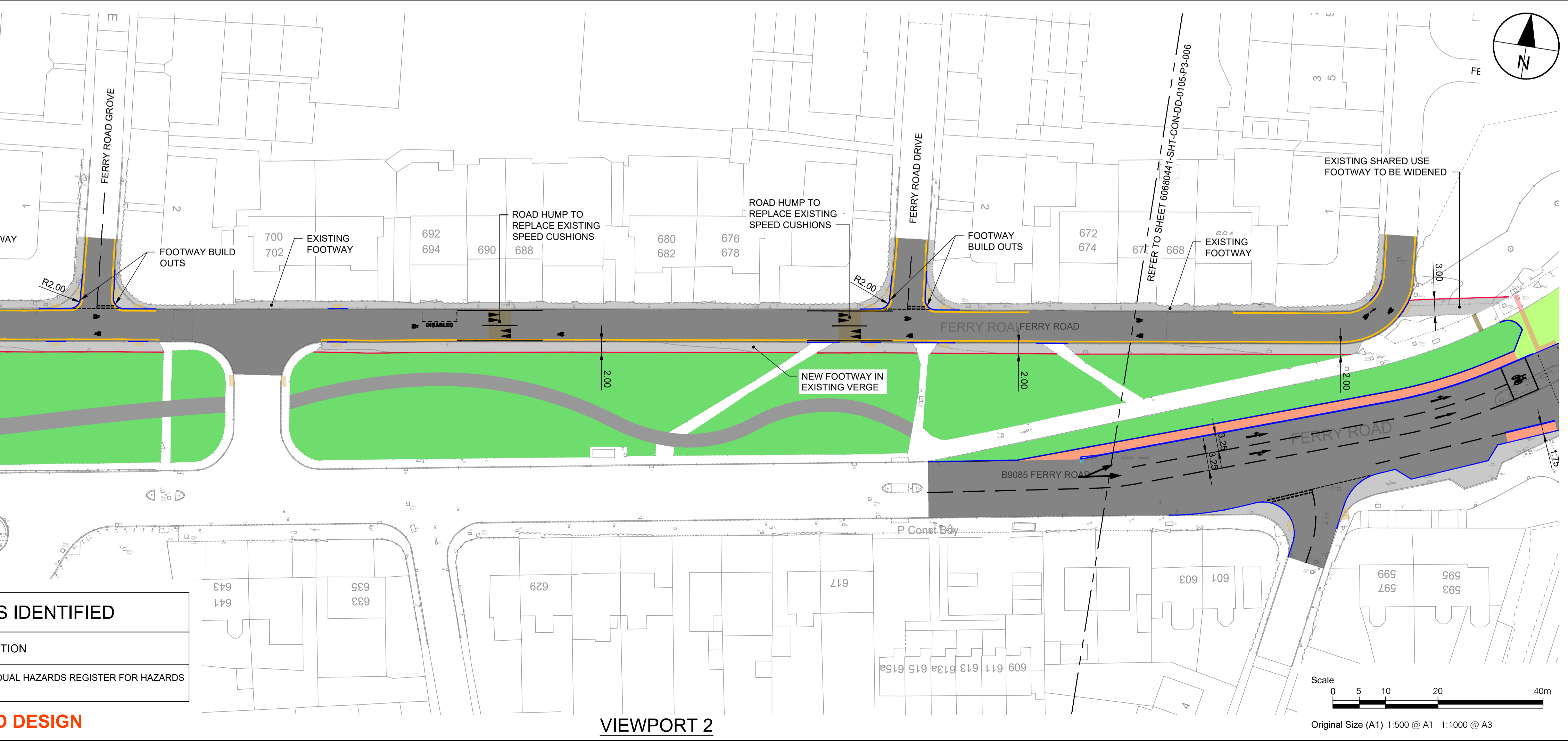

RESIDUAL HAZARDS IDENTIFIED	
ITEM	DESCRIPTION
1	REFER TO APPENDIX 1/23 - DESIGNER'S RESIDUAL HAZARDS REGISTER FOR HAZARDS IN RELATION TO THESE WORKS

**ISSUE STATUS: DEVELOPED DESIGN**

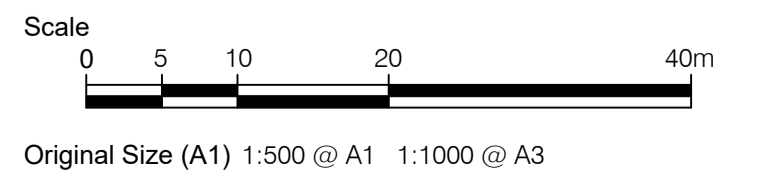
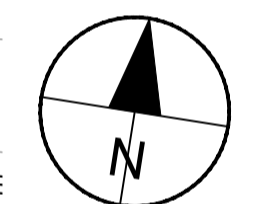
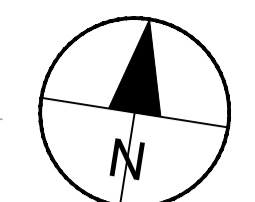

**AECOM**

**PROJECT**  
 NORTH EDINBURGH CONNECTIONS

North Edinburgh Connections

**CLIENT**  
 EDINBURGH THE CITY OF EDINBURGH COUNCIL

**CONSULTANT**  
 AECOM  
 1 Tanfield  
 EDINBURGH, EH3 5DA  
 +44 (0) 131 301 8600 tel  
 +44 (0) 131 301 8699 fax  
 www.aecom.com

- NOTES**
- ALL DIMENSIONS ARE IN METRES UNLESS STATED OTHERWISE. ALL LEVELS ARE IN METRES AND RELATE TO ORDNANCE DATUM.
  - DO NOT SCALE FROM ANY DRAWING. WORK TO FIGURED DIMENSIONS ONLY.
  - ALL WORKS BY THE CONTRACTOR MUST BE CARRIED OUT IN SUCH A WAY THAT ALL REQUIREMENTS UNDER THE HEALTH AND SAFETY AT WORK ACT ARE SATISFIED.
  - ALL WORK IS TO BE CARRIED OUT IN COMPLIANCE WITH THE REQUIREMENTS OF THE STATUTORY AUTHORITIES AND CONSTRUCTION DESIGN AND MANAGEMENT REGULATIONS.

**ISSUE/REVISION**

I/R	DATE	DESCRIPTION

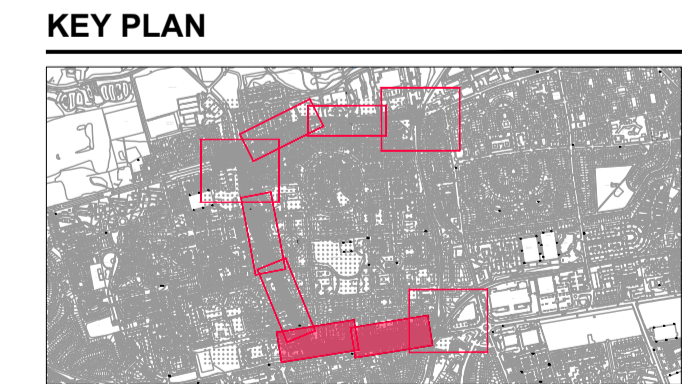

**PROJECT NUMBER**  
60680441

**SHEET TITLE**  
GENERAL ARRANGEMENT SHEET 5 OF 6

**SHEET NUMBER**  
60680441-SHT-CON-DD-0105-P3-005

File name: \\AECOM\NET\COM\FS\EMEA\EDINBURGH\UK\ED4\DCS\PROJECTS\CIC06080441\_NEAT\_CONNECTIONS\900\_CAD\_GIS\910\_CAD20-SHEETS\DEVELOPED DESIGN  
 2026080441-SHT-CON-DD-0105-P3-003 - GENERAL ARRANGEMENT.DWG  
 Last saved by: SWANSONAJ Last Plotter: 2026-05-16  
 Project Management Initials: Designer: Checked: Approved: ISO A1 841mm x 841mm

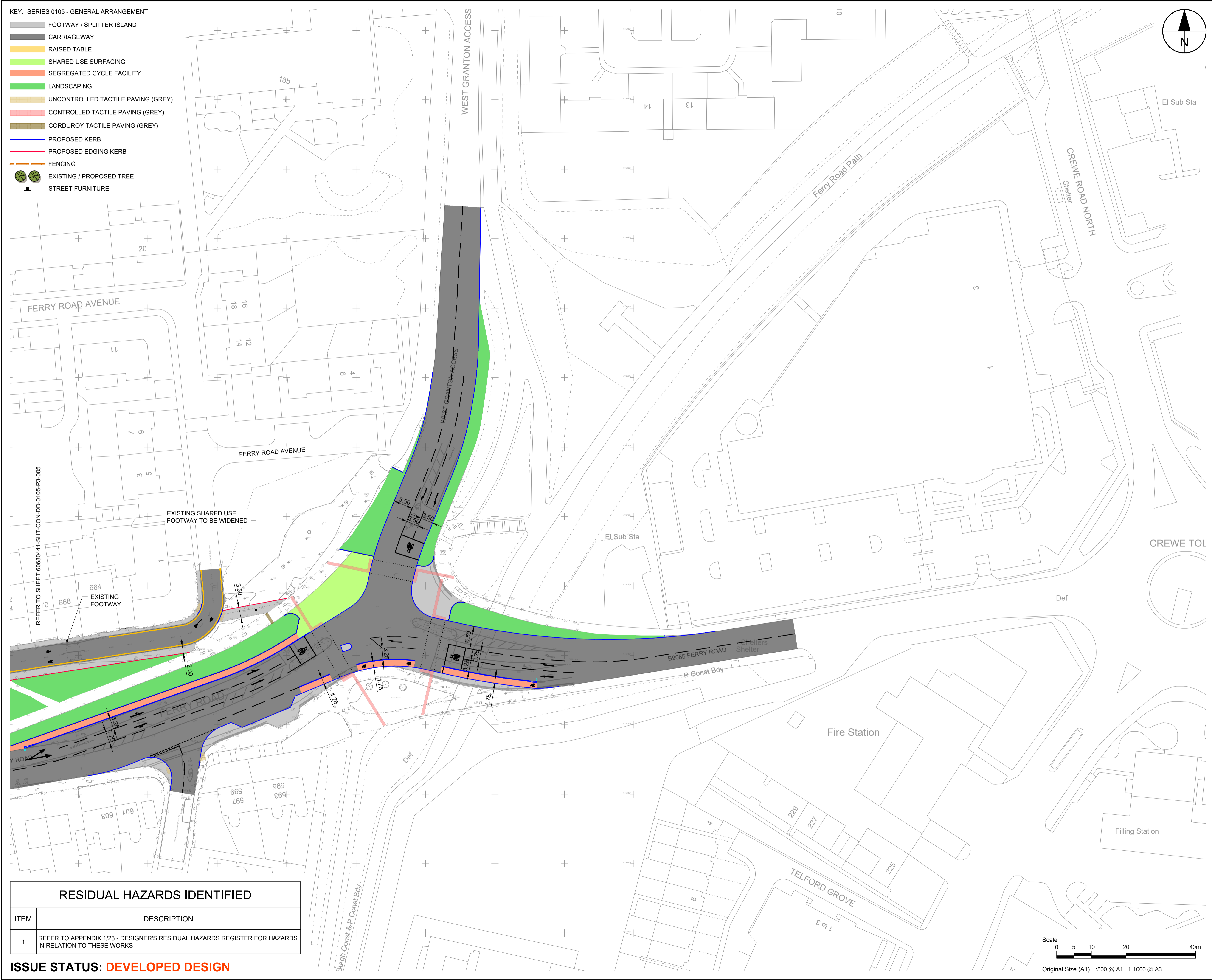

- KEY: SERIES 0105 - GENERAL ARRANGEMENT**
- FOOTWAY / SPLITTER ISLAND
  - CARRIAGEWAY
  - RAISED TABLE
  - SHARED USE SURFACING
  - SEGREGATED CYCLE FACILITY
  - LANDSCAPING
  - UNCONTROLLED TACTILE PAVING (GREY)
  - CONTROLLED TACTILE PAVING (GREY)
  - CORDUROY TACTILE PAVING (GREY)
  - PROPOSED KERB
  - PROPOSED EDGING KERB
  - FENCING
  - EXISTING / PROPOSED TREE
  - STREET FURNITURE

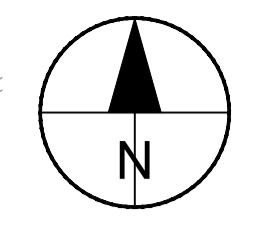

**AECOM**

**PROJECT**  
NORTH EDINBURGH CONNECTIONS

**Client**  
 North Edinburgh Connections

**CLIENT**  
 EDINBURGH THE CITY OF EDINBURGH COUNCIL

**CONSULTANT**  
AECOM  
1 Tanfield  
EDINBURGH, EH3 5DA  
+44 (0) 131 301 8600 tel  
+44 (0) 131 301 8699 fax  
www.aecom.com

- NOTES**
1. ALL DIMENSIONS ARE IN METRES UNLESS STATED OTHERWISE. ALL LEVELS ARE IN METRES AND RELATE TO ORDNANCE DATUM.
  2. DO NOT SCALE FROM ANY DRAWING. WORK TO FIGURED DIMENSIONS ONLY.
  3. ALL WORKS BY THE CONTRACTOR MUST BE CARRIED OUT IN SUCH A WAY THAT ALL REQUIREMENTS UNDER THE HEALTH AND SAFETY AT WORK ACT ARE SATISFIED.
  4. ALL WORK IS TO BE CARRIED OUT IN COMPLIANCE WITH THE REQUIREMENTS OF THE STATUTORY AUTHORITIES AND CONSTRUCTION DESIGN AND MANAGEMENT REGULATIONS.

**ISSUE/REVISION**

I/R	DATE	DESCRIPTION

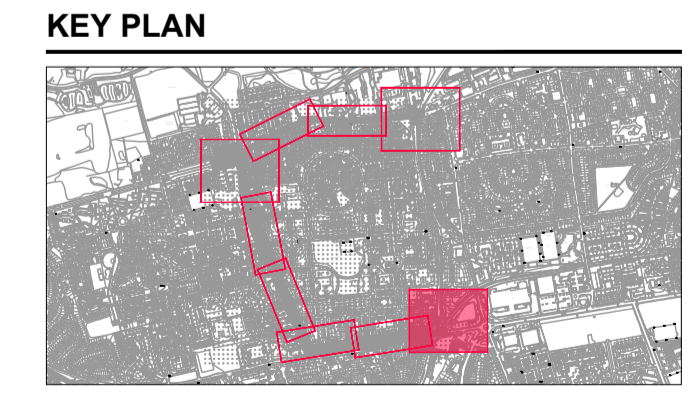

**PROJECT NUMBER**  
60680441

**SHEET TITLE**  
GENERAL ARRANGEMENT SHEET 6 OF 6

**SHEET NUMBER**  
60680441-SHT-CON-DD-0105-P3-006

**RESIDUAL HAZARDS IDENTIFIED**

ITEM	DESCRIPTION
1	REFER TO APPENDIX 1/23 - DESIGNER'S RESIDUAL HAZARDS REGISTER FOR HAZARDS IN RELATION TO THESE WORKS

**ISSUE STATUS: DEVELOPED DESIGN**

