

Typical Tree Pit Detail A

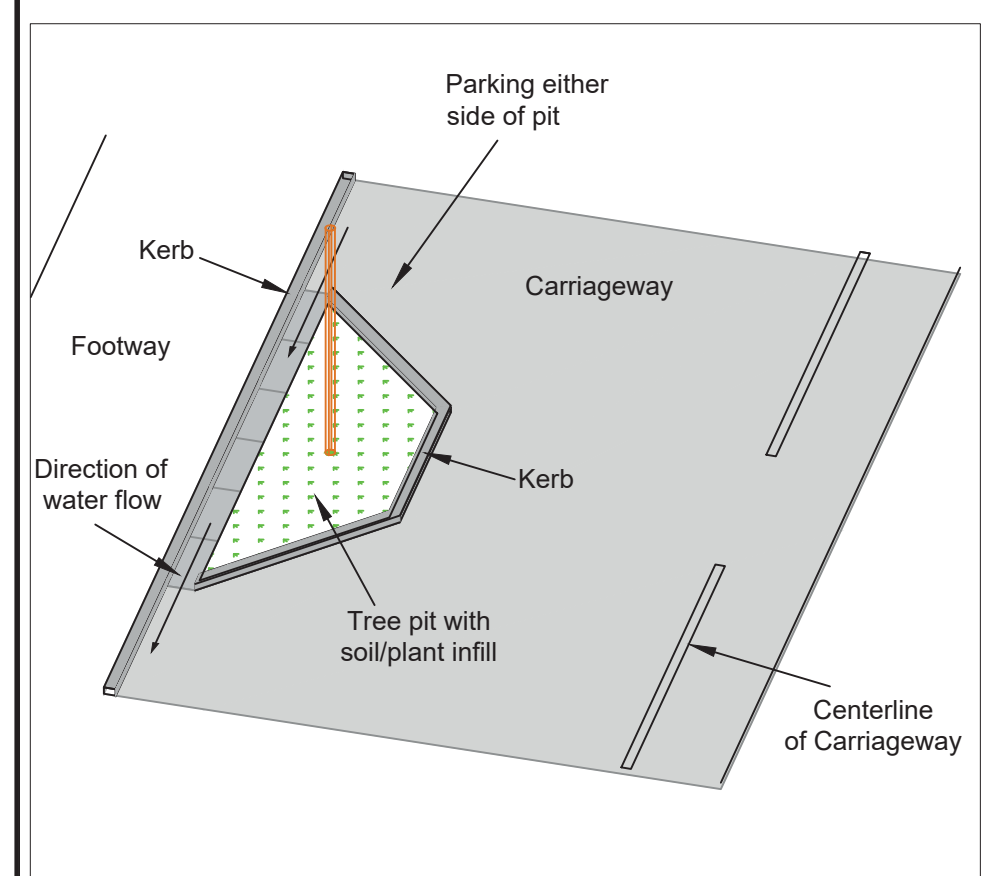

Typical Tree Pit Detail B

Note that the tree pit infill shown in the two details above are for consultation purposes only and are subject to change. The infill shall be either a soiled area with plants or an arbor resin surface.

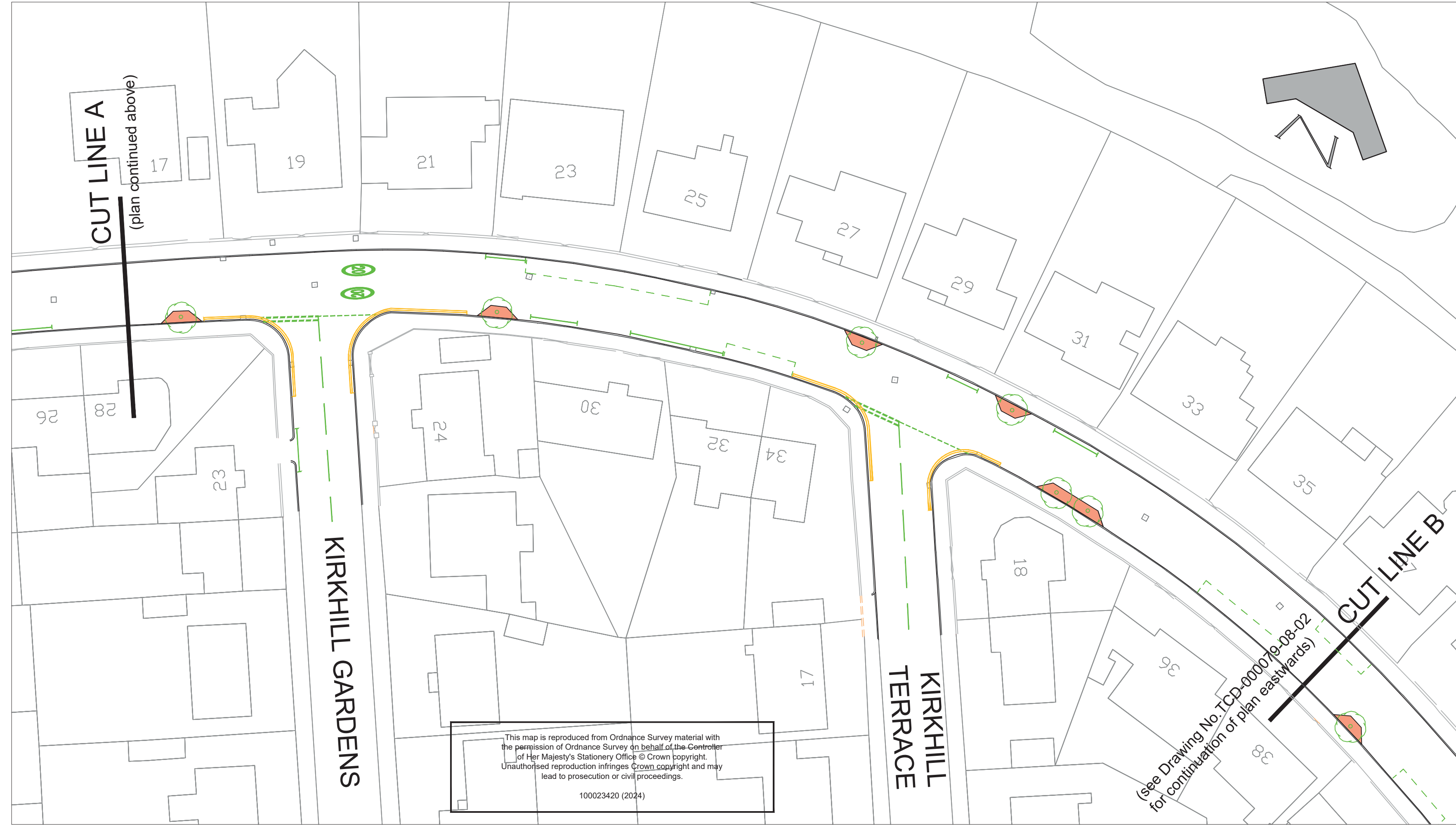

Photos of typical Tree Pits located elsewhere in the City

This map is reproduced from Ordnance Survey material with the permission of Ordnance Survey on behalf of the Controller of Her Majesty's Stationery Office © Crown copyright. Unauthorised reproduction infringes Crown copyright and may lead to prosecution or civil proceedings.
100023420 (2024)

(see Drawing No. TCD/000079/08-02 for continuation of plan eastwards)

REVISION	DETAILS	BY	DATE	CHECKED

• EDINBURGH •
THE CITY OF EDINBURGH COUNCIL

The City of Edinburgh Council
Waverley Court
4 East Market Street
Edinburgh, EH8 8BG
Telephone: 0131 200 2000

OPERATIONAL SERVICES
ROADS AND INFRASTRUCTURE
TRANSPORT CONTRACTS AND DESIGN

PRIESTFIELD ROAD
STREET TREES

Date: 30/08/2024 Job No.: 000079 Drawn by: WK
Scale: 1:400 @A1 Checked by: TB