

WAVEGARDEN BRIDGE AND CYCLE LINK PRE-APPLICATION ENGAGEMENT

PROPOSED BRIDGE DESIGN

FOOTBRIDGE

- Shared-use (cycle and pedestrian) crossing over the Union Canal at Ratho.
- Links the EICA and a proposed Country Park and Craig Park residential development, both located on the south side of the canal.
- Linked to the existing canal towpath by means of a new cycleway ramp.
- Single span, simply-supported steel-beam footbridge.
- 26m span and 4m wide.
- Weathering steel main girders and recycled plastic with timber effect deck planks and parapets.
- Full height reinforced concrete abutments and spread foundations.
- Exposed faces of abutments and wing walls will be clad with a natural stone finish.

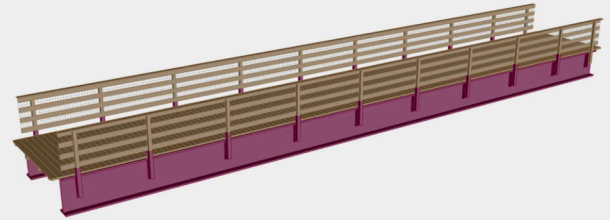

SHARED CYCLE/PEDESTRIAN BRIDGE DESIGN AND VISUALISATION OF THE SCHEME

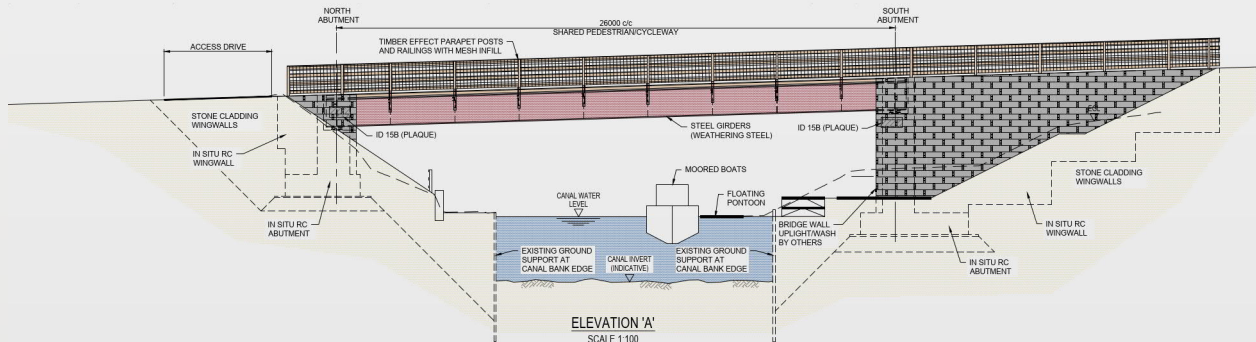

GROUND CONDITIONS

- Preliminary ground investigations were conducted in April 2019.
- Boreholes indicated that ground conditions at bridge abutments consisted of a depth of topsoil and granular made ground/fill over natural granular deposits.
- Dolerite bedrock was encountered at 5.1m and 3m depth at the north and south abutment respectively.
- Groundwater strikes were recorded coincident with rockhead.

